

**GUILDFORD BOROUGH COUNCIL AND
SURREY COUNTY COUNCIL**

GUILDFORD JOINT COMMITTEE

DATE: 19 September 2018



LEAD OFFICER: ANDY HARKIN, PARKING MANAGER, GUILDFORD BOROUGH COUNCIL

SUBJECT: GUILDFORD ON-STREET PARKING REVIEW AND SCOPING REPORT

AREA(S) AFFECTED: ALL

SUMMARY OF ISSUE:

As part of the Guildford Parking strategy, a Parking review is conducted every 18 months. This report presents the issues that have been raised to date and recommends the actions and next steps.

RECOMMENDATIONS:

The Guildford Joint Committee is asked to agree:

- (i) to formally advertise Surrey County Council's intention to make an order to give effect to proposals at the following locations:
 - a. **Merrow Street** – Merrow Resident Association and residents report that cars parked on both sides because of chicanes and access issues, especially for emergency or large vehicles. When entering Merrow Street from Epsom Road you are immediately on the wrong side of the road. Double yellow lines are too short and need to be extended. Controls are required. (Development plan for Merrow Street in ANNEXE 4).
 - b. **Hareward Road** – Non-residents, mainly construction vehicles from Dial a truck, park on crest of the hill causing drivers to go round bend on wrong side of road and at times meet oncoming traffic. Obstruction of road and visibility causing Hazard. (Development plan for Harewood Road in ANNEXE 5).
 - c. **Stoughton Road** – Stoughton residents experience problems with blocked driveways, especially on drop-off and pick-up times for school. Parking on both sides and close to the junction causes visibility issues and problems turning or passing. Controls are required. (Development plan for Stoughton Road in ANNEXE 6).
 - d. **Stoughton Road** – Stoughton, an existing disabled bay outside Nos. 313/315, is no longer required as resident moved away. Plan to convert bay to free unrestricted parking place. (Development plan for Stoughton Road in ANNEXE 7).

- e. **Artillery Terrace** – Disabled Bay request made. GBC agreed to advisory disabled bay, which will be formalised in next review. (Development plan for Artillery Terrace in ANNEXE 8).

If any representations are received, they will be considered by the Parking Manager in consultation with the Chairman, Vice Chairman and relevant Local Ward and Divisional Members. If no representations are received, the Traffic Regulation Order (TRO) will be made.

The TRO would involve publishing a public notice, erecting street notices, placing documentation on deposit and writing to those in the immediate vicinity of the proposals.

The above plans are expected to take no more than 12 months to develop using existing resources and the Parking Manager’s delegated powers.

(ii) To refer the following items for review by the newly established Parking and Air Quality Working Group:

- (a) The retrospective exclusion of new residential developments of 6 dwellings or more, in the controlled parking zone areas A, B, C and D, from accessing the permit scheme to ensure demand does not further outstrip supply. See section 2.8 (ii).
- (b) to review the recommendations from the Guildford borough Council Overview & Scrutiny (O&S) Committee in conjunction with comments made in section 6 relating to the additional resources and extended timetable to achieve a positive outcome. The recommendations are as follows and shown at ANNEXE 1).

O&S Committee Recommendations	
A	Parking controls in Area A, B, D and northern section of Area C, be extended to operate 8.30am to 9pm, 7 days a week
B	Free limited waiting shared use bays within Area A, B and the northern section of Area C, be changed to charged dual user bays
C	Pay and display, including RingGo, be extended into the residential areas of the Controlled Parking Zone
D	The possible contribution of RingGo to the costs of extending the pay by phone signage through CPZ be progressed
E	The limit on permits in Area D of the Controlled Parking Zone be increased, in the first instance by 5% (Parking Officers recommend to increase by 10%)
F	On a case by case basis, the less well-used pay and display only bays be converted into dual use, this is to say, made available to permit holders
G	The limit on issuing adjacent permits for Area A be lowered and that Area A adjacent permits no longer be issued in relation to a second car

H	Area A permit holders be allowed to access Area E
I	Saturday parking controls in the norther section of Area J be removed
J	In addition to visitors permit scratch cards, RingGo or a similar pay by phone system be offered as an option for visitors parking (Parking officer recommend “Virtual payment system” not just RingGo or Pay by phone)
K	To accompany the extended controls into evenings and Sundays, the annual household limit on visitor scratch cards be doubled

Note: items in red above are further recommendations by Parking Officers

- (c) To gain councillor feedback in relation to the CPZ/Non-CPZ parking requests lists to enable the Parking Manager to develop proposals for the “Local” issues shown in ANNEXE 2 & 3. If the proposals are likely to be uncontroversial, the Parking Manager can use delegated powers to progress them, in consultation with the Chairman, Vice Chairman and relevant Local Ward and Divisional Members. If the proposals are expected to generate significant comment, then they will be reported back to the Committee with a view to seeking authority to formally advertise them.

To develop and implement the above items would take 48-60 months with existing resources. Therefore, the Parking and Air Quality Working Group are also asked to consider the scope and resource implications.

REASONS FOR RECOMMENDATIONS:

To assist with safety, access, traffic movements, increase the availability of space and its prioritisation for various user-groups in various localities, and make local improvements.

1. INTRODUCTION AND BACKGROUND:

1.1 During the 2016-2018 review period, the following was agreed by the committee:

- i. that reviews are combined and deal with issues both in the CPZ and Non-CPZ areas.
- ii. that reviews are limited in scope to deal with around 50 items / locations, and prioritisation is given to safety issues.
- iii. that major schemes / changes are only considered if residents / businesses can demonstrate significant support of such amendments.
- iv. that disabled bay, vehicle crossover and less controversial issues are fast-tracked, and formally advertised as early in the review process as possible.

- v. increase the level of delegation of Parking Manager/Officer to approve proposals if they are uncontroversial, in conjunction with the Chairman, Vice-Chairman and relevant Local Ward and Divisional Members. This would reduce the need to return to the Committee where everyone agrees to a proposal, to reduce the number of reports having to be presented to the committee and to expedite the review process.

2. ANALYSIS:

2.1 Requests for parking changes have been collated from three sources:

- i. Requests made directly to the Parking Manager up to July 2018. These are explained in 2.2 and 2.3 below.
- ii. Parking Manager/Officer recommendations as explained in 7(i).
- iii. Recommendations received from the Guildford Borough Council Overview and Scrutiny Committee, summarised in 7(ii).

2.2 The Parking Manager receives requests from residents, business owners, commuters, Parish Councils and others. Some have been closed for a variety of reasons such as being dealt with as part of previous revisions or referred on for resolution outside of parking.

2.3 There remain **550 requests in total**, broken down as follows:

- i. **CPZ.** There are **207 CPZ** requests, which appear in ANNEXE 2. These have been put in Ward, CPZ zone then Road order, and then summarised into the nature of the request and whether the issue is a “Local” one, or involves “Area-wide” considerations. From the requests there are 108 separate roads, 152 are “Area wide” and 55 are “Local”.
- ii. **Non-CPZ.** There are **343 Non-CPZ** requests, which appear in ANNEXE 3. These have been put in Ward and then Road order and then summarised into the nature of the request and whether the issue is a “Local” one, or involves “Area-wide” considerations. From the requests there are 251 separate roads, 290 are “Area wide”, 52 are “Local” and 1 is classed as part “Area wide” and “Local”.

2.4 By way of explanation, ‘Local’ issues involve the possibility of altering of one or two restrictions in a specific location.

ANNEXES 2 & 3 identify individual requests for ‘Local’ changes to the parking scheme. With these localised requests for changes, we would not expect those proposing them to show they had support from other households because they only affect a limited area.

2.5 ‘Area-wide’ requests tend to involve the amendment of controls over wider areas, or fundamental changes to the way that the controls / permit scheme operates.

ANNEXES 2 & 3 identify individual requests for 'Area-wide' changes to the parking scheme. These requests relate to different 'Area-wide' issues in various localities.

'Area-wide' issues raised include changes to the operational hours of the permit scheme, the prioritisation of spaces, and residents and visitors permit eligibility in various localities.

Within the CPZ area, some of these issues may be considered by the scope of the O&S Committee report. However, a number of others are not, although petitions/parking scheme request forms have not been received regarding what could potentially be significant changes.

Other Considerations

2.6 Requests have also been received which relate to other parking schemes however none have included parking scheme forms or petitions to show clear evidence of the support within that location and so cannot be progressed. These requests are for:

- i. **London Road** – Burpham
- ii. **Mill Lane** - Pirbright
- iii. **Southway** – Westborough
- iv. **Springfield Road** – Holy Trinity
- v. **St Lukes Square** – Holy Trinity
- vi. **Manor Fields** – Seale
- vii. **Ardmore Avenue** – Stoughton

2.7 Petitions have been received for the following locations. The Committee may wish to consider these alongside the other parking requests received and shown in ANNEXES 2 & 3, (highlighted in *Orange*):

- i. **Madrid Road** – Onslow, remove permit prioritisation within parking bay immediately outside shops to improve accessibility.
- ii. **Wilderness Road** – Onslow, convert unrestricted parking to 4 hours max to resolve concerns about non-resident parking bays in Northern part of road.

3. OPTIONS:

3.1 The Committee could choose to advertise the recommendations in 7(i) and if so would take an estimated 12 months to implement.

3.2 The Committee could choose to progress a 50 location review and if so, this would take an estimated 18-24 months to implement. The Committee could choose to take some recommendations forward and substitute others in favour of others deemed priorities, based on the feedback.

- 3.3** The Committee could choose to implement more than the 50 items, taking into consideration that the reviews and implementation may take longer than 18-24 months, unless they were able to find additional funding for further resources to speed up the process.
- 3.4** The Parking and Air Quality Working Group could choose to progress the O&S report. On its own would take 24-36 months. If done alongside 3.3 it would take 48-60 months.
- 3.5** The Committee could choose not to formally advertise and progress the proposals. However, the issues that have been raised, and in many cases confirmed by the informal consultation, would remain unresolved.
- 3.6** After a proposal is advertised, any objections received would be reviewed with the Chairman, Vice-Chairman and relevant Local Ward and Divisional Members, to agree if the Parking Manager/Officer can use their delegated powers to proceed, or if objections need to be reported back to the Committee and a decision taken whether to implement the proposal, or implement less restrictive proposals. If there were a requirement to increase the amount of restrictions as a result of comments received, the proposals would have to be advertised again.

4. CONSULTATIONS:

- 4.1** Discussions will be held with Local Borough and County Councillors, once we have a steer from the Parking and Air Quality Working Group, about the work that can be progressed for development.

5. FINANCIAL IMPLICATIONS:

- 5.1** If the Committee agrees to implement the proposed items in 7(i) and 7(ii) funding will come from the Guildford on-street parking account. Existing resources will be used to conduct the consultations and the only additional expenditure will be printing and postage. Although public exhibitions are not anticipated, if the need arises, where possible they will be held at Council facilities.
- 5.2** The standard 50 location if taken from ANNEXE 2 & 3 (option 3.2) would take 18-24 months to implement and would be approx. £50,000 using existing resources.
- 5.3** If the O&S items 7(ii) (option 3.4) are approved on its own, based on the scope of work required this is likely to extend the timescales between 24-36 months. Investigation, development and implementation of the O&S report recommendations is estimated to cost up to £700,000.
- 5.4** If 3.4 was pursued at the same time as option 3.2 and the Committee wanted to retain a two-year turnaround, this additional demand would require a further FTE or the services of a consultant to develop proposals, draft legal documents, procure services of contractors, equipment provision and oversee implementation and introduction of amendments.
- 5.5** If all issues highlighted by the O&S report were to be progressed, the number of sign changes for operation hour changes and pay by phone technology would

be significant. This would involve a significant number of sign changes and in some cases post changes. It is likely that RingGo, the current provider for the “pay by phone” technology, would be prepared to fund some of the associated signage. If not, then the cost to change all signage would increase accordingly.

6. WIDER IMPLICATIONS:

Area assessed:	Direct Implications:
Crime and Disorder	No significant implications arising from this report.
Sustainability (including Climate Change and Carbon Emissions)	Set out below.
Corporate Parenting/Looked After Children	No significant implications arising from this report.
Safeguarding responsibilities for vulnerable children and adults	No significant implications arising from this report.
Public Health	No Significant implications arising from this report.
Human Resource/Training and Development	Set out below.

Sustainability implications

- 6.1** Parking sits alongside Climate Change and Air Quality within the strategies that feed into the Surrey Transport Plan. Therefore, in many respects, these strategies and sustainability are inter-dependant.
- 6.2** Preventing parking in locations where it would otherwise cause safety and access issues, and in particular, impede traffic, helps reduce congestion, the resultant journey times and pollution. This can be particularly important on bus routes, where large vehicles utilise relatively narrow roads.

Human Resource Implications

- 6.3** Whilst pay and display is more efficient to enforce than limited waiting, the outcome of the O&S report would involve regular on-street enforcement over an extended period, to include evenings and Sundays across much of the town centre CPZ. The extended operation hours would equate to more than a 50% increase in on-street enforcement.
- 6.4** Early analysis shows that to implement the O&S report will require 1 additional supervisor and 6-8 additional CEOs. The extended hours would impact on enforcement officers and their worktime patterns. This needs to be discussed with staff and their representatives.
- 6.5** This will also impact on the administration and processing for penalty charge notices (PCN) and permits due to anticipated increases in volumes.
- 6.6** The operation of extended enforcement hours is expected to be self-financing.

7. CONCLUSION AND RECOMMENDATIONS:

7.1 The Guildford Joint Committee is asked to agree:

- (i) to formally advertise Surrey County Council's intention to make an order to give effect to the proposals for the following locations;

Planned for developed proposals in ANNEXES noted below

- a. Merrow Street** – Merrow Resident Association and residents report that cars parked on both sides because of chicanes and access issues, especially for emergency or large vehicles. When entering Merrow Street from Epsom Road you are immediately on the wrong side of the road. Double yellow lines are too short and need to be extended. Controls are required. (Development plan for Merrow Street in ANNEXE 4).
- b. Hareward Road** – Non-residents, mainly construction vehicles from Dial a truck, park on crest of the hill causing drivers to go round bend on wrong side of road and at times meet oncoming traffic. Obstruction of road and visibility causing Hazard. (Development plan for Harewood Road in ANNEXE 5).
- c. Stoughton Road** – Stoughton residents experience problems with blocked driveways, especially on drop-off and pick-up times for school. Parking on both sides and close to the junction causes visibility issues and problems turning or passing. Controls are required. (Development plan for Stoughton Road in ANNEXE 6).
- d. Stoughton Road** – Stoughton, an existing disabled bay outside Nos. 313/315, is no longer required as resident moved away. Plan to convert bay to free unrestricted parking place. (Development plan for Stoughton Road in ANNEXE 7).
- e. Artillery Terrace** – Disabled Bay request made. GBC agreed to advisory disabled bay, which will be formalised in next review. (Development plan for Artillery Terrace in ANNEXE 8).

If any representations are received, they will be considered by the Parking Manager in consultation with the Chairman, Vice Chairman and relevant Local Ward and Divisional Members. If no representations are received, the Traffic Regulation Order (TRO) will be made.

This would involve publishing a public notice, erecting street notices, placing documentation on deposit and writing to those in the immediate vicinity of the proposals.

The above are planned to take no more than 12 months to develop. This would involve publishing a public notice, erecting street notices, placing documentation on deposit and writing to those in the immediate vicinity of the proposals. This would involve using existing resources and the Parking Manager's delegated powers to develop proposals and consider representations, therefore providing a quicker turnaround.

(ii) To refer the following items for review by the newly established Parking and Air Quality Working Group:

- (a) retrospective exclusion of new residential developments of 6 dwellings or more, in the controlled parking zone areas A, B, C and D. from accessing the permit scheme to ensure demand does not further outstrip supply. See section 2.8 (ii).
- (b) to review the recommendations from the Overview & Scrutiny (O&S) Committee in conjunction with comments in section 6 related to the additional resources and extended timetable to achieve a positive outcome – (see below and ANNEXE 1).

O&S Committee Recommendations	
A	Parking controls in Area A, B, D and northern section of Area C, be extended to operate 8.30am to 9pm, 7 days a week
B	Free limited waiting shared use bays within Area A, B and the northern section of Area C, be changed to charged dual user bays
C	Pay and display, including RingGo, be extended into the residential areas of the Controlled Parking Zone
D	The possible contribution of RingGo to the costs of extending the pay by phone signage through CPZ be progressed
E	The limit on permits in Area D of the Controlled Parking Zone be increased, in the first instance by 5% (Parking Officers recommend to increase by 10%)
F	On a case by case basis, the less well-used pay and display only bays be converted into dual use, this is to say, made available to permit holders
G	The limit on issuing adjacent permits for Area A be lowered and that Area A adjacent permits no longer be issued in relation to a second car
H	Area A permit holders be allowed to access Area E
I	Saturday parking controls in the norther section of Area J be removed
J	In addition to visitors permit scratch cards, RingGo or a similar pay by phone system be offered as an option for visitors parking (Parking officer recommend “Virtual payment system” not just RingGo or Pay by phone)
K	To accompany the extended controls into evenings and Sundays, the annual household limit on visitor scratch cards be doubled

Note: items in red above are further recommendations by Parking officers

- (c) Gain councillor feedback in relation to the CPZ/Non-CPZ parking requests lists to enable the Parking Manager/Officer to develop proposals for the “Local” issues shown in ANNEXE 2 & 3. If the proposals are likely to be uncontroversial, the Parking Manager can use delegated powers to progress them, in consultation with the Chairman, www.surreycc.gov.uk/guildford

Vice Chairman and relevant Local Ward and Divisional Members. If the proposals are expected to generate significant comment, then they will be reported back to the Committee with a view to seeking authority to formally advertise them.

The scope of the above items to develop and implement would take 48-60 months with existing resources. Therefore, the Parking and Air Quality Working Group are asked to consider the scope and resource implications.

8. WHAT HAPPENS NEXT:

- 8.1** If the Committee agrees to advertise the proposals set out in recommendations 7(i), it is likely that this will take place within 12 months. This would involve publishing a public notice, erecting street notices, placing documentation on deposit and writing to those in the immediate vicinity of the proposals. The feedback will be discussed with local county councillors and the Parking Manager will consult with the Chairman, Vice Chairman and relevant Local Ward and Divisional Members of the Committee prior to proceeding.
- 8.2** In respect of items (ii) in section 7 further consideration by the Parking and Air Quality Working Group is required, to provide a steer on requirements due to the resource and timescale implications, explained in this report. Once agreed, discussion will be held with relevant Local Borough and County Councillors and where appropriate, proposals developed, with a view to reporting these back to the Committee meeting, seeking authority to formally advertise them.

Contact Officer:

Andrew Harkin, Parking Manager, Guildford Borough Council
(01483) 444535

Consulted:

Local Ward and Divisional Councillors

Annexes:

- 1 - Proposals from Overview & Scrutiny Committee *(for review by the Parking & Air Quality Working Group)*
- 2 - List of parking change requests received –CPZ *(for review by the Parking & Air Quality Working Group)*
- 3 - List of parking change requests received – Non CPZ *(for review by the Parking & Air Quality Working Group)*
- 4 - Merrow Street development plan
- 5 - Harewood Road development plan
- 6 - Stoughton Road development plan – revision to existing plan
- 7 - Stoughton Road development plan -conversion of disabled bay
- 8 - Artillery Terrace development plan

Background papers:

none

Recommendations proposed by the Overview & Scrutiny Committee – ANNEXE 1

	O&S Committee Recommendations
A	Parking controls in Area A, B, D and northern section of Area C, be extended to operate 8.30am to 9pm, 7 days a week
B	Free limited waiting shared use bays within Area A, B and the northern section of Area C, be changed to charged dual user bays
C	Pay and display, including RingGo, be extended into the residential areas of the Controlled Parking Zone
D	The possible contribution of RingGo to the costs of extending the pay by phone signage through CPZ be progressed
E	The limit on permits in Area D of the Controlled Parking Zone be increased, in the first instance by 5% (Parking Officers recommend to increase by 10%)
F	On a case by case basis, the less well-used pay and display only bays be converted into dual use, this is to say, made available to permit holders
G	The limit on issuing adjacent permits for Area A be lowered and that Area A adjacent permits no longer be issued in relation to a second car
H	Area A permit holders be allowed to access Area E
I	Saturday parking controls in the northern section of Area J be removed
J	In addition to visitors permit scratch cards, RingGo or a similar pay by phone system be offered as an option for visitors parking (Parking officer recommend "Virtual payment system" not just RingGo or Pay by phone)
K	To accompany the extended controls into evenings and Sundays, the annual household limit on visitor scratch cards be doubled

This page is intentionally left blank

CPZ List for Consideration - ANNEXE 2

Division / Ward	CPZ Area	Road	Location	Issue / Request	Reason Given	Area-wide / Local
Christchurch	I	Aldersey Road	near No.14	present 2-kerb setback distance to adjacent bays is insufficient.	Safety & Access	Local
Christchurch	I	Tormead Road	near No.7	wants unrestricted bays converted to time limited bays to reduce all day parking and increase their availability to residents and their visitors.	Access & Availability of Space	Local
Christchurch	I	Tormead Road	cul-de-sac	non-permit-holding residents abusing the system and using the unrestricted bays.	Access & Availability of Space	Local
Christchurch	I	Albury Road	3rd parking bay (1)	3rd Parking bay overlaps drop kerb at No 1 so making it difficult to maneuver in/out more difficult	Parking Restriction Rev	Local
Christchurch	I	Aldersey Road		Wants measures to prevent parking by camper vans	Environmental	Area-wide
Christchurch	I	Cranley Road		Ask if can remove the park restrictions down Cranley Rd (nxt to sch) over weekend. Visitors can only park for 2 hrs even though they are empty. They were original only weekdays	Parking Restriction Rev	Area-wide
Christchurch	I	Epsom Road		Wants greater flexibility for organisations to acquire business / operational permits to allow them to park close to their place of work.	Flexibility	Area-wide
Christchurch	I	Linfield Gardens (just outside CPZ)		Inconsiderate parking and lack of parking causing issues.	Access & Availability of Space	Area-wide
Edgehill	I	Lower Edgeborough road	outside Edgehill (6)	Reduction of free Parking Bay Request in front of edgehill, 6 blocks of flats. Due to restricted visibility & bin collection issue with bins of pavement	Parking Restriction Rev	Local
Friary & St Nicolas	A	31 Artillery Terrace		request for disabled bay	Disabled Bay Request	local
Friary & St Nicolas	A	Artillery Rd / Artillery Tr / George Rd	near Boiler Room	complaints about parking associated with venue.	Access & Availability of Space	Area-wide
Friary & St Nicolas	A	Artillery Rd / Artillery Tr / George Rd		Wants residents from Area D to be prevented from parking in Area A.	Access & Availability of Space	Area-wide
Friary & St Nicolas	A	Artillery Road		Wants extended controls hours and restrictions on the number of skips allowed in any one area.	Access & Availability of Space	Area-wide
Friary & St Nicolas	A	Artillery Road		wants individual spaces marked within the bays and 'drop off' bays provided.	Access & Availability of Space	Area-wide
Friary & St Nicolas	A	Artillery Road		Suggest Area A have 2 hr bays and permit bays, after 18.00 anyone can park & limit Area A to 1 car permit.	Parking Permit Rev - Zone	Area-wide
Friary & St Nicolas	A	Artillery Terrace		Wants a 24-hour scheme, more spaces, more permit only, and a ban on skips.	Access & Availability of Space	Area-wide
Friary & St Nicolas	A	Artillery Terrace		accessibility issues for large vehicles servicing premises.	Access & Availability of Space	Area-wide / Enforcement
Friary & St Nicolas	A	Church Road		lack of parking in evenings causes issues.	Access & Availability of Space	Area-wide
Friary & St Nicolas	A	Church Road		there are too many permits issued for the number of spaces provided, and allowances should be made when spaces are temporarily suspended.	Access & Availability of Space	Area-wide
Friary & St Nicolas	A	Dapdune Road		Want measures to prevent local businesses from 'playing the system' and shuffling cars.	Access & Availability of Space	Area-wide
Friary & St Nicolas	A	Gardner Road		Wants stringent permit eligibility checks to ensure permits are not being misacquired by those with o-ff-street parking.	Access & Availability of Space	Area-wide
Friary & St Nicolas	A	Gardner Road		Wants individual spaces marked within the bays	Access & Availability of Space	Area-wide
Friary & St Nicolas	A	George Road		constantly find it difficult to park in the evening. Want more spaces created, DYLS converted to SYLs and operational hours extended.	Access & Availability of Space	Area-wide
Friary & St Nicolas	A	George Road		When Yellow Lines to be repainted on Artillery Terrace in front & opposite Shaftesbury Hall & potential of bollard or lines on Illegal Off Street Parking on Council Land	Parking Restriction Req	Area-wide
Friary & St Nicolas	A	Leas Road		lack of restrictions on Sundays means that anyone can park in the bays.	Access & Availability of Space	Area-wide

Division / Ward	CPZ Area	Road	Location	Issue / Request	Reason Given	Area-wide / Local
Friary & St Nicolas	A	Markenfield Road	near Nettles Terrace	opportunities to increase availability of parking through changes to existing controls should be explored.	Access & Availability of Space	Local
Friary & St Nicolas	A	Markenfield Road		wants greater flexibility to acquire more visitor permits, particularly for building works.	Access & Availability of Space	Area-wide
Friary & St Nicolas	A	Markenfield Road		Wants ability to acquire more visitor permits, particularly during building work.	Flexibility	Area-wide
Friary & St Nicolas	A	William Road		Permit Request to allow pregnant wife & later pram access to front. At Back slippery stair and feel a risk. (Initial request delinced due to 2 berth bay behind house).	Parking permit Req	local
Friary & St Nicolas	A	William Road		Residents use shared-use spaces making it extremely difficult for bonafide visitors to find a space. Additionally, the limits on visitor permits, particularly when building work is required, causes issues.	Access & Availability of Space	Area-wide
Friary & St Nicolas	B	Denzil Road		Wants residents permit only throughout through the removal of shared use	Access & Availability of Space	Area-wide
Friary & St Nicolas	B	Denzil Road		Lack of parking in evenings causes issues. Wants SYLs and DYLS converted to spaces.	Access & Availability of Space	Area-wide
Friary & St Nicolas	B	Farnham Road	between Guildford Park Road and Denzil Road	parking on footway outside control hours of SYLs causes issues.	Safety & Access	Local
Friary & St Nicolas	B	Farnham Road		Lack of parking causes issues.	Access & Availability of Space	Local
Friary & St Nicolas	B	Millmead Terrace area		Wants new development to be permit free and SYL opposite his garage converted to DYL.	Access & Availability of Space	Local
Friary & St Nicolas	B	Millmead Terrace, 5 Bellairs Apt		having previously converted from LW to PO, request to change some back to LW	Parking Bay Rev	Area-wide
Friary & St Nicolas	B	Rupert Road		parking by non-permit holders outside present operational hours of scheme causes issues.	Access & Availability of Space	Area-wide
Friary & St Nicolas	B	Testard Road area		Lack of parking outside the present control hours combined with the number of permits issued and area boundaries cause issues.	Availability & Flexibility	Area-wide
Friary & St Nicolas	B	Upperton Road		Non resident with the same zone park on upperton rd in the morning as near to Train stn leaving less parking for resident. Also Cars from the takeaway and rentals also add to the problem. Can we have our our Zone parking	Parking Restriction Req - Access	Area-wide
Friary & St Nicolas	D	Bedford Road (off street	Bedford House, top of Friary car park	Request for on street permits be used for offstreet. Has Zone D permit, which not suitable for carers.	Parking permit Req	Local
Friary & St Nicolas	D	Bedford Road area		Increase prioritisation of spaces for residents and greater flexibility for those in private developments to acquire permits.	Access & Availability of Space	Area-wide
Friary & St Nicolas	D	Martyr Road		Wants P&D only bays made dual-use	Access & Availability of Space	Local
Friary & St Nicolas	D	Martyr Road		General lack of space particularly when projects are ongoing in the area, which is often in a town centre location.	Access & Availability of Space	Area-wide
Friary & St Nicolas	D	Martyr Road		Wants greater flexibility for permits, removal of the threshold and the ability for permits to be issued to two vehicles within Area D on first moving to the area. To accommodate this, wants all pay & display only bays made dual-use, or more made permit only.	Access & Availability of Space	Area-wide
Friary & St Nicolas	D	Martyr Road		Lack of parking particularly at weekends and outside the present control hours of the scheme. Wants all spaces in vicinity to be permit holders only.	Access & Availability of Space	Area-wide
Friary & St Nicolas	D	Martyr Road		Lack of parking particularly at weekends and outside the present control hours of the scheme.	Access & Availability of Space	Area-wide
Friary & St Nicolas	D	Martyr Road		Lack of parking particularly on Sundays. Wants consideration to allow residents to use off-street public car parks on Sundays, as well as evenings.	Access & Availability of Space	Area-wide
Friary & St Nicolas	D	Martyr Road		Lack of parking particularly at weekends and outside the present control hours of the scheme.	Access & Availability of Space	Area-wide
Friary & St Nicolas	D	Millmead		Parking used Millmead as no park in Bury str. H/E due to inconsiderate parking spaces an not be used. Suggest either paint individual bays. Also asked if addit visitor permits will be avail	Parking Restriction Req	Area-wide

Division / Ward	CPZ Area	Road	Location	Issue / Request	Reason Given	Area-wide / Local
Friary & St Nicolas	D	North Street	North Street, near marks and spencer	Resident ask for disabled bays at taxi rank	Parking Restriction Req	local
Friary & St Nicolas	D	North Street		Unhappy that disabled bays taken over by taxi rank that rarely used.	Parking Restriction Rev	local
Friary & St Nicolas	D	Woodbridge Road	52 Woodbridge Road, Flat 6 Pavillion Hse	Was declined as has lease car through boyfriends company - see notes if any exception	Parking Permit Req	local
Friary & St Nicolas	D	Leapale Road	o/s Pub	Wants loading restriction removed or transferred to opposite side of road	Access & Availability of Space	Local
Friary & St Nicolas	E	Josephs Road	opp. No.26	Wants SYL opposite driveway converted to DYL to improve access.	Access & Availability of Space	Local
Friary & St Nicolas	E	Josephs Road	near Enterprise Rent A Car	wants permit only controls in nearby bays to prevent misuse by Enterprise.	Access & Availability of Space	Local
Friary & St Nicolas	E	Josephs Road / Springside Court (private spaces)	near Enterprise Rent A Car	misuse of private spaces by Enterprise, as well as those in Josephs Road	Access & Availability of Space	Local
Friary & St Nicolas	E	Josephs Road / Springside Court (private spaces)	near Enterprise Rent A Car	misuse of private spaces by Enterprise, as well as those in Josephs Road	Access & Availability of Space	Local
Friary & St Nicolas	E	Joseph's Road, Springside Court	just out of CPZ	Insufficient parking for amount of flats	Parking Restriction Req	Area-wide
Friary & St Nicolas	E	Langley Close	just out of CPZ	Request for resident parking permit with no time restriction, due to congestion by non residents	Parking Permit Req - Residents	Area-wide
Friary & St Nicolas	E	Langley Close (just outside CPZ)		wants allocated parking for residents	Access & Availability of Space	Area-wide
Friary & St Nicolas	E	Langley Close (just outside CPZ)		wants spaced marked out and controls introduced.	Safety, Access & Availability of Space.	Area-wide
Friary & St Nicolas	E	Langley Close (just outside CPZ)		occasional accessibility issues	Access & Availability of Space	Area-wide
Friary & St Nicolas	E	Langley Close (just outside CPZ)		wants spaces marked out and controls introduced to resolve various inconsiderate parking issues.	Safety, Access & Availability of Space.	Area-wide
Friary & St Nicolas	E	Recreation Road		use of Rec. on Friday afternoons and on weekends cause issues.	Access & Availability of Space	Area-wide
Friary & St Nicolas	E	Recreation Road		parking outside present control hours an issue, particularly as it is caused by non-residents	Access & Availability of Space	Area-wide
Friary & St Nicolas	E	Recreation Road		wants residents' motorcycles to be exempt from the permit scheme.	Flexibility	Area-wide
Friary & St Nicolas	F	Bray Road		Want all spaces in cul-de-sac section to be permit only.	Access & Availability of Space	Local
Friary & St Nicolas	F	Bray Road		wants greater prioritisation for permit holders to deter visitors to hospital parking on-street	Access & Availability of Space	Local
Friary & St Nicolas	F	Bray Road	btwn 59-61 Bray Road	Renew Yellow lines + Crossover for private drive between 59 and 61 Bray Road, request that you provide more width beyond the gateposts because it is extremely difficult to back into the drive when cars are parked right up to the edge	Yellow Line Req - Renewal	Area-wide
Friary & St Nicolas	F	Mountside	'upper' section	Wants greater flexibility to acquire residents' permits.	Access & Availability of Space	Area-wide
Friary & St Nicolas	F	Nethermount	opp. No.3	Parking bay opposite driveway causes access issues	Access & Availability of Space	Local
Friary & St Nicolas	G	Chestnut Avenue	section nearest Portsmouth Road	wants bays closest Portsmouth Road made permit only and individual spaces marked within shorter bays.	Access & Availability of Space	Local
Friary & St Nicolas	G	Chestnut Avenue		Since redevelopment of barratt hse, further from portsmouth rd, dropped kerb has been restored, can this space be given to resident for 2 hour bays.	Parking Bay Req	Area-wide

Division / Ward	CPZ Area	Road	Location	Issue / Request	Reason Given	Area-wide / Local
Friary & St Nicolas	G	Devon Bank	o/s No.4	Wants restrictions removing directly outside property to allow parking across own driveway.	Access & Availability of Space	Area-wide
Friary & St Nicolas	G	Guildown Road		Wants measures to prevent residents with vans and camper vans from being able to park them on-street.	Environmental	Area-wide
Friary & St Nicolas	G	Guildown Road	17a	Clarification of Rules - restriction of large vehicles	Permit eligibility	local
Hambleton	A	Dapdune / Walnut Tree Close		problem charging electric cars as either 2 slow or in bays only allow 2 hours	Parking Permit Rev	Area-wide
Holy Trinity	I	Epsom Road		Cars parked along pavement/rd w/out Auth, shortening width of road causing hazard	Parking Restriction Req - Safety & Access	Area-wide
Holy Trinity	I	Epsom Road (39)		Cars parked along pavement/rd w/out Auth, shortening width of road causing hazard. 39 epsom road	Parking Restriction Req - Safety & Access	Area-wide
Holy Trinity	A	Eagle Road		Availability of space issues, particularly in the evenings, appears to be caused by non-residents. Inefficiently parked vehicles are also an issue. That coupled with the use of the road as a rat run, speeding casues various issues.	Safety, Access & Availability of Space.	Area-wide
Holy Trinity	A	Falcon Road		there is a severe shortage of space at weekends and evenings.	Access & Availability of Space	Area-wide
Holy Trinity	A	Foxenden Road		problems with obstruction due to lack of available of space in evenings.	Access & Availability of Space	Area-wide / Enforcement
Holy Trinity	A	Foxenden Road		has to park on yellow lines due to lack of availability of space in evenings.	Access & Availability of Space	Area-wide
Holy Trinity	A	Foxenden Road		Even though pay Permits almost impossible to park near road/hse due to town users or church service users. Also parked cars on Dbl yellow lines on junctions after permit hr of 6pm, which can cause obstruction. Can the same restrictions not be made for roads surrounding G-Live.	Parking Restriction Rev	Area-wide
Holy Trinity	A	Queens Road		Wants operational hours of scheme extended to deal with issues caused by non-residents	Access & Availability of Space	Area-wide
Holy Trinity	A	Springfield Road		constantly find it difficult to park in the evening.	Access & Availability of Space	Area-wide
Holy Trinity	A	Springfield Road		Wants extended control hours, more permit only and restrictions on households with more than 2 vehicles.	Access & Availability of Space	Area-wide
Holy Trinity	A	Springfield Road		Residents can not parking weekdays & sundays in road due to non residents and those in new flats. Can resident parking be issued 7 days up to 9pm + flats not given resident parking	Resident parking Scheme Req	Area-wide
Holy Trinity	A	Victoria Road		subdivision of properties has caused serious availability of space issues in the evening. This is not helped by the controls finishing at 6pm and the impact of non-residents.	Access & Availability of Space	Area-wide
Holy Trinity	A	Victoria Road		Insufficient space in evenings and at weekends	Access & Availability of Space	Area-wide
Holy Trinity	A	Walnut Tree Close	164 Walnut Tree Close	O & S review	Part of O&S report	Area-wide
Holy Trinity	A	Walnut Tree Close		since Oct17 impossible to find free spaces due to demand & student accomodation, station users and business permit users	Parking Restriction Req	Area-wide
Holy Trinity	A	Falcon Road	near No.44	There is undoubtedly a parking problem in the area. Residents using bays make it difficult for those with care workers and relatives that provide care.	Access & Availability of Space	Area-wide
Holy Trinity	B	Bury Fields	the Court	No Residents parking for The court and not enough parking. Unfair free parking at Milmead. Looking for resolution	Parking permit Req	Area-wide
Holy Trinity	B	Ludlow Road		parking by non-permit holders outside present operational hours of scheme causes issues.	Access & Availability of Space	Area-wide
Holy Trinity	B/F	The Mount	o/s No.35	Wants shared-use bay converted to a 24/7 permit only bay, due to issues, particularly on Sundays.	Access & Availability of Space	Area-wide
Holy Trinity	B/F	The Mount	o/s No.37	Wants the whole of The Mount to be in one Area, rather than split between B and F, or for permits to be valid in both areas.	Access & Availability of Space	Area-wide

Division / Ward	CPZ Area	Road	Location	Issue / Request	Reason Given	Area-wide / Local
Holy Trinity	C	Addison Road		Wants greater flexibility to accommodate the needs of multicar households.	Flexibility	Area-wide
Holy Trinity	C	Addison Road		Insufficient space particularly in the evenings. Wants more limited permit eligibility.	Access & Availability of Space	Area-wide
Holy Trinity	C	Addison Road		Lack of parking, particularly in the evenings and at weekends, but conversely, wants more flexibility regarding visitor permits.	Access & Availability of Space	Area-wide
Holy Trinity	C	Addison Road		More signage needed as Parents on school pick up ignore existing signage and park in bays	Parking Signage Rev - Additional Permit signs	Area-wide
Holy Trinity	C	Addison Road area		not enough space, too many permits issued cause issues, particularly outside the current operational hours.	Access & Availability of Space	Area-wide
Holy Trinity	C	Clandon Road	6	Require more permits as planning permission was for only 1 car. Decline sent as has space for 2-3	Parking Permit Req	Area-wide
Holy Trinity	C	Cline Road		Lack of parking, particularly in the evenings and at weekends.	Access & Availability of Space	Area-wide
Holy Trinity	C	Cline Road		Insufficient Parking sugg 1-road permit only, 2-no more than 2 cars, 3-no vans, 4-take away permits for those parking over 2 spaces to save for 2nd car	Parking Restriction Req	Area-wide
Holy Trinity	C	Pewley Way	59	Relocation of controlled parking bay request, due to reconstructing bin area and restricting moving bins	Parking Restriction Rev-Bay Relocation	local
Holy Trinity	C	St Catherines Park (just outside CPZ)		Inconsiderate parking away from existing controls causing issues.	Safety & Access	Local
Holy Trinity	C	Warren Road		wants greater flexibility for multicar households to acquire residents' permits	Flexibility	Area-wide
Holy Trinity	C	Waterden Road		Lack of parking, particularly in the evenings and at weekends. Wants 24/7 scheme.	Access & Availability of Space	Area-wide
Holy Trinity	C	St Lukes Square		Provided template to complete to request resident parking scheme	Resident parking Scheme Req	Area-wide
Holy Trinity	D	Brodie Road		Wants greater flexibility to acquire Area D permits as there are capacity issues in Area H, and spare capacity in roads such as Pewley Hill and Harvey Road. Additionally, there is scope to create additional spaces in Pewley Hill and Semaphore Road (Area H).	Access & Availability of Space	Area-wide
Holy Trinity	D	Brodie Road		Residents (Zone D) can not park near to home in evening due to congestion of non resident cars. Looking for solution like Dene Road & G-Live	Parking Permit Rev	Area-wide
Holy Trinity	D	Brodie Road		D Pmt revoked due to hard grnd, h/e vehicles regularly blocked. Other residents with D have this issue. Dbl yellow lines wont help as CEO infrequent.	Parking Restriction Rev	local
Holy Trinity	D	Castle Street	access between Nos.38&39	Wants existing DYs bolstered to prevent loading and unloading.	Access & Availability of Space	Local
Holy Trinity	D	Cheselden Road	26	Zone D parking permit required, have 2 small children + Wife having physio due to back problems, also question if some parking in and around should be revised to accomoate residents. Reqd also for H for 2nd car	Parking Permit Req - Zone D & H	local
Holy Trinity	D	College Road		Should be greater flexibility to acquire Area D permits as there is spare capacity in roads such as College Road and often not in Area A.	Access & Availability of Space	Area-wide
Holy Trinity	D	College Road	College Road, car park	We have drop kerb + single line to car park but people are parking on Sunday or evening blocking access.	Dbl Yellow line Req	Local
Holy Trinity	D	College Road	10	Told Wait list for Permits but my road has a lot of space a lot, pictures to show peak times. Is the wait list a mistake?	Parking Permit Req	Local
Holy Trinity	D	College Road	College Road, 1 Bellerby apartments	Moved into Bellerby Apt, request parking permit as only 4 spaces for 7 flats	Parking Permit Req	Local
Holy Trinity	D	Dene Road		Wants greater flexibility to acquire more visitor permits, and for them to be cheaper.	Flexibility	Area-wide
Holy Trinity	D	Dene Road		Relaxed permit eligibility	Parking Permit Rev	Area-wide
Holy Trinity	D	Dene Road		Parking congestion in Zone A and not able to park. Having to use car parks and pay, complaint that not heard about parking permit	Parking Permit Chaser - Access prob	Area-wide

Division / Ward	CPZ Area	Road	Location	Issue / Request	Reason Given	Area-wide / Local
Holy Trinity	D	Epsom Road	between Jenner and Hunter Roads	Want DYLS throughout as parking on SYLS in this section still causes issues.	Safety & Access	Local
Holy Trinity	D	Epsom Road	opp. No.43	Wants SYL opposite converted to DYL to prevent parking	Safety & Access	Local
Holy Trinity	D	Guildford High Street, Royal Grammar School		Request for Red lines or red hatched area as entrance to school being obscured by parked cars and hazard	Parking Restriction Req	Area-wide
Holy Trinity	D	Haydon Place-access door or Canapy coffee ltd	62	Renovated + outside acces door is yellow line + requires converting to Dbl yellow EXT (like front) as impact trade + visibility?	Dbl Yellow Line Rev	local
Holy Trinity	D	Hunter Road		The impact of parking associated with the Glive extends beyond the Dene Road area, and reduces the availability of space for those living in the wider area.	Access & Availability of Space	Area-wide
Holy Trinity	D	Jenner Road		Insufficient Zone D parking for residents have to park elsewhere then move cars, looking for solution	Parking Permit Rev	Area-wide
Holy Trinity	D	Jenner Road		Due to congestion not able to park on resident parking bays, only pay and display. Asked if pay & display could be permit also?	Parking Restriction Req	Area-wide
Holy Trinity	D	Oxford Road	3	Request review of how permits for oxford road initiated. On wait list (41) even though the road is almost empty daily + initially had one but had to hand back when out of country. 70 years old????	Parking Permit Req	local
Holy Trinity	D	Oxford Road area		Wants greater flexibility to acquire Area D permits as Area H is too distant and unsafe after dark, and there is spare capacity in roads such as Pewley Hill and Harvey Road.	Access & Availability of Space	Area-wide
Holy Trinity	D	Oxford Road area		Due to availability of space issues caused by non-residents, wants evening and Sunday controls introduced, to prioritise space and resolve inconsiderate parking on yellow lines.	Safety, Access & Availability of Space	Area-wide
Holy Trinity	D	Pannells Court	Graham House development	Concerns about impact of 14 unit residential development within Area D.	Access & Availability of Space	Local
Holy Trinity	D	Sandfield Terrace		Permit Revision request for Sandfield Terrace to have similar extented parking restrictions and seven day a week D enforcement	Parking Permit Req - D	Area-wide
Holy Trinity	D	Sydenham Road		Wants greater flexibility to acquire Area D, particularly when the off-street parking at an address does not meet current standards.	Access & Availability of Space	Area-wide
Holy Trinity	D	Town Centre		RingGo expansion request to have available all on street CP	RingGo Expansion Req	Area-wide
Holy Trinity	D	Tunggate Square area		Should be greater flexibility to acquire Area D permits as Area H is too distant, and there is spare capacity in roads such as Pewley Hill and Harvey Road.	Flexibility	Area-wide
Holy Trinity	D	York Road area		parking by non-permit holders in evening and at weekends causes issues.	Access & Availability of Space	Area-wide
Holy Trinity	D	Yvonne Arnaud access road (GBC private)	disabled bays	wants spaces formalised to prevent misuse	Access & Availability of Space	Local
Holy Trinity	D	Brodie Road		Wants greater flexibility for visitor permits, particularly for building works.	Flexibility	Area-wide
Holy Trinity	D/H	Semaphore Road		wants permit only spaces to accommodate D/H permit holders, or increased flexibility to acquire permits in Area D	Access & Availability of Space	Area-wide
Holy Trinity	E	Stocton Road		Wants individual spaces marked within the bays	Access & Availability of Space	Area-wide
Holy Trinity	E	Stocton Road		parking associated with Rec. (Sunday morning football) causes issues.	Safety, Access & Availability of Space.	Area-wide
Holy Trinity	E	Stocton Road		Wants greater ability for multi-car households to acquire more residents' permits.	Flexibility	Area-wide
Holy Trinity	H	Chantry Quarry (private)		Wants private road to be eligible for on-street residents' and visitor parking permits.	Flexibility	Area-wide
Holy Trinity	H	Chantry Quarry (private)		Wants private road to be eligible for on-street residents' and visitor parking permits.	Flexibility	Area-wide
Holy Trinity	H	Chantry Quarry (private)		Wants private road to be eligible for on-street residents' and visitor parking permits.	Flexibility	Area-wide
Holy Trinity	H	Chantry Quarry (private)		Wants private road to be eligible for on-street residents' and visitor parking permits.	Flexibility	Area-wide

Division / Ward	CPZ Area	Road	Location	Issue / Request	Reason Given	Area-wide / Local
Holy Trinity	H	Fort Road	2	Request for additional parking permits while work being carried out	Parking permit Req	local
Holy Trinity	H	Hillier Road		REF FM00969064 - More prk at hillier road for school pick up	Addition Parking Req	Area-wide
Holy Trinity	H	Semaphore Road		No parking for residents in Zone H due to 2 hour free parking	Parking Permit Rev	Area-wide
Holy Trinity	H	Tilehouse Road		position of parking bay close to driveway causes issues.	Safety & Access	Local
Holy Trinity	H	Tilehouse Road		Permit holder causing obstruction, due to size other vehicles have to mount the pavement/verge causing damage	Parking Restriction Req	local
Holy Trinity	H	Warwicks Bench		Wants greater prioritisation for permit holders or ability to acquire a permit for Area D	Access & Availability of Space	Area-wide
Holy Trinity	I	Lancaster Avenue		congestion of cars makes deliveries & other vehicles access difficult. Also impacts on safety. Large vehicles like waste have to straddle the kerb. Questions what options available and are resident permits possible.	Parking Permit Req - Residents	local
Holy Trinity	I	Lancaster Avenue		Require parking restrictions Residents find it difficult to get on/off drives due to congestion in Road as a free car park.	Parking Restriction Req	Area-wide
Holy Trinity	I	Lancaster Avenue area (just outside CPZ)		inconsiderate parking causes issues.	Safety, Access & Availability of Space	Area-wide
Holy Trinity	I	Lancaster Avenue area (just outside CPZ)		some residents have been threatening towards pupils, even when they park sensibly.	Access & Availability of Space	Area-wide
Holy Trinity	I	Rosetrees (just outside CPZ)		parking in evenings and weekends particularly problematic.	Safety, Access & Availability of Space	Area-wide
Holy Trinity	Variou us	Various		Wants a new town centre zone, permit only throughout Artillery Road / Church Road / George Road area, and greater flexibility for residents in the area around the town centre to park in the Borough Council's car parks.	Access & Availability of Space	Area-wide
Holy Trinity	Variou us	Various		Need to make public our intention to reorganise the town centre permit zones.	Access & Availability of Space	Area-wide
Holy Trinity & Christchurch	C	Clandon Road		parking for prolonged periods by vehicles, including camper vans, is an issue.	Availability of space & Environmental	Area-wide
Holy Trinity & Friary & St Nicolas	A	Area A in general		Wants extension of controls hours and more spaces to be made permit only.	Access & Availability of Space	Area-wide
Holy Trinity & Friary & St Nicolas	A	Area A in general		Wants those who choose to rent garages to have their eligibility for on-street permits reduced accordingly.	Access & Availability of Space	Area-wide
Holy Trinity & Friary & St Nicolas	A	Area A in general		Need for greater prioritisation (Permit only and extended control hours)	Access & Availability of Space	Area-wide
Holy Trinity & Friary & St Nicolas	C	Area C in general		Lack of parking, particularly in the evenings and at weekends.	Access & Availability of Space	Area-wide
Holy Trinity & Friary & St Nicolas	D	Area D in general		Wants more permit only and dual-use parking to reduce need for adjacent area permits reducing availability of space for Permit A residents.	Access & Availability of Space	Area-wide
Holy Trinity & Friary & St Nicolas	D	Area D in general		Wants greater flexibility to allow residents of private development to acquire on-street permits.	Flexibility	Area-wide
Holy Trinity & Friary & St Nicolas	D	Area D in general		On-street Pay by Phone	Flexibility	Area-wide
Merrow	I	Epsom Road		Land Encroachment of parked & derelict cars parked	Parking Restriction Req	Area-wide
Onslow	B	Guildford Park Avenue		Wants greater permit flexibility to accommodate multicar households in location with little permit pressure and where absent landlords retain the use of the garage associated with the address for their own use.	Flexibility	Area-wide
Onslow	B	Guildford Park Avenue		Wants greater permit flexibility to accommodate multicar households in location with little permit pressure	Flexibility	Area-wide
Onslow	B	Guildford Park Avenue		Wants permits to be issued to vulnerable user-groups who do not have access to a garage due to the wishes of their landlord.	Flexibility	Area-wide

Division / Ward	CPZ Area	Road	Location	Issue / Request	Reason Given	Area-wide / Local
Onslow	F	Madrid Road		Petition to change 2 hour bay	Petition to Rev 2 hr bay	Area-wide
Onslow	F	Poltimore Road		Wants greater permit flexibility to accommodate multicar households in location with little permit pressure	Flexibility	Area-wide
Onslow	F	Sandalwood		Want more flexible permit eligibility to take into account temporary situations such as pregnancy and having young children.	Flexibility	Area-wide
Onslow	F	Sandalwood		Wants greater permit flexibility to accommodate households whose garages, whilst useable, are tight.	Flexibility	Area-wide
Onslow	J	Alresford Road	No.9	Possible creation of hardstand / VCO may require changes to controls	Access & Availability of Space	Local
Onslow	J	Alresford Road		Wants measures to prevent parking by camper vans	Environmental	Area-wide
Onslow	J	Alresford Road	13	Have 5 cars between 2 houses + only allow 2 cars on drive + 2 permits. Road is congested with cars and would like more spaces in front of the house?	Parking Permit Req	Area-wide
Onslow	J	Area J - Onslow Village		Wants consistency and feels that it is unfair that residents in the Onslow Village extension have the flexibility to park without needing a permit whilst those elsewhere within Area J do.	Access & Availability of Space	Area-wide
Onslow	J	Area J - Onslow Village		Review of Unrestricted bays	Access & Availability of Space	Area-wide
Onslow	J	Area J - Onslow Village		Removing Saturday controls from Onslow Village	Access & Availability of Space	Area-wide
Onslow	J	Area J - Onslow Village		Small extension to the CPZ required in Manor Way.	Access & Availability of Space	Area-wide
Onslow	J	East Mead	37 East Meads	Due to work on drive the parking bay in front of house need to be moved + query on gaining permits	Parking Bay Move Req	Local
Onslow	J	Friars Gate		Degree of prioritisation is unnecessary as there is always a significant excess of space to vehicles.	Flexibility	Area-wide
Onslow	J	High View Road (just outside CPZ)	o/s Nos.27-28	Possible curtailment of DYLS near junction.	Access & Availability of Space	Local
Onslow	J	Litchfield Way	o/s Nos.4-6	Wants bay o/s Nos.4-6 converted to permit only, along with all those in the E-W section of the road.	Access & Availability of Space	Area-wide
Onslow	J	Manor Way (just outside CPZ)	east of Abbots Close	Although it may be against the wishes of the residents there, wants the CPZ to extend to the junction with Abbots Close.	Safety & Access	Area-wide
Onslow	J	Manor Way (just outside CPZ)	east of Abbots Close	Cyclist continue to meet motorists coming the other way in the section where unbroken lengths of parking are still permitted.	Safety & Access	Area-wide
Onslow	J	Old Court Road		Wants allocated spaces as non-permit holders regularly occupy all spaces in the evenings.	Access & Availability of Space	Area-wide
Onslow	J	Orchard Road	near No.5	Wants bay relocated / removed because space when occupied by oversized vehicle causes issues.	Safety & Access	Local
Onslow	J	Orchard Road		Require enforcement, large vehicles too large for bays, blocking driveways + cause hazard & visibility. Normally either side of no 5	Parking Restriction + Enforcement	local
Onslow	J	Queen Eleanors Road	near school	Concerns about school run	Safety & Access	Area-wide
Onslow	J	Stag Hill		Removal of bays from Arlesford Road	Parking Bay Rev	local
Onslow	J	The Chase, Oval		I have a parking permit but difficult to park due to students. Is it possible to have some more permit bays	Parking Bay Req	local
Onslow	J	The Square		Wants the bay outside Williams made parallel and the one adjacent to the post box removed.	Safety & Access	Local
Onslow	J	Vicarage Gate		Wants measures to prevent long term parking.	Parking restriction Req	Area-wide
Onslow	J	Wilderness Road	junction with A3	wants restrictions extended to kerblines of A3	Safety & Access	Local

Division / Ward	CPZ Area	Road	Location	Issue / Request	Reason Given	Area-wide / Local
Onslow	J	Wilderness Road		Wants unrestricted bays to become time limited	Safety & Access	Area-wide
Onslow	J	Wilderness Road		Petition for 26 residents for Parking changes. To change parking to 4 hours max to help with parking congestion of non residents	Parking Restriction Rev	Area-wide
Shalford	G	Ferry Lane		Wants Ferry Lane to become its own distinct zone, residents' only and possibly even P&D	Access & Availability of Space	Area-wide
Shalford	G	Ferry Lane		wanted change to bay width + making permit only. Amend width and make permit only	Parking Bay Rev - Permit only	Area-wide
Shalford	H	Chantry Road	53	Want to reduce size of parking bay outside house as planning permission in for access way	Parking Bay Rev - Reduce Bay	local
Shalford	H	Chantry View Road		Parking bays on blind bend traffic hazard	Parking Restriction Req - Safety	Area-wide
Shalford / Friary	G	Sandy Lane	towards Law College below Beechwood hse	Repaint yellow line on Sandy lane (towards Law College below Beechwood hse) as cars parking. This reduces width of road & becoming dangerous.	Parking Restriction Req	local
Unsorted	D	Various		Wants consideration to be given to households' circumstances, rather than just the availability of off-street space and number of vehicles kept, when issuing permits and prioritising on waiting list (prioritisation could include: lone women walking home late at night, pregnant ladies, families with young children, non-blue badge warranting medical issues, the elderly).	Access & Availability of Space	Area-wide

This page is intentionally left blank

Non-CPZ List for Consideration - ANNEXE 3

Division(s) / Ward(s)	Road	Location	Issue / Request	Reason Given	Area-wide / Local
All	All	pavement parking*	motorists park on pavements causing issues for other road users, particularly parents with children and those with disabilities. Wants borough-wide ban on pavement parking	Safety, Access & Environmental	Area wide
All	All		wants HGVs use of residential roads for parking to be restricted	Environmental	Area wide
Ash	Ash Hill Road*	in vicinity of Dover Garage	footway parking causes safety and access issues and raises maintenance concerns. Also Parish asked if commercial cars for sale can be parked on public highway	Safety, Access & Environmental	Area wide
Ash	Ash Hill Road*	junction with View Road	inconsiderate parking in vicinity of junction causes issues	Safety & Access	Area wide
Ash	Ash Hill Road*	Bollards	Bollards not effective as cars get through & abandoned	Safety, Access & Environmental	Local
Ash	Ashdene Road	junction with York Road	parking in vicinity of junction causes issues	Safety & Access	Area wide
Ash	Burrwood Gardens	in vicinity of No.11	a specific household are parking inconsiderately and obstructively, part on the pavement.	Safety & Access	local
Ash	Chandlers Road*	2007 restrictions	on occasion obstruction is still caused despite recently introduced restrictions although off carriageway parking has been introduced making some of restriction surplus to requirements.	Safety & Access	Area wide
Ash	Chandlers Road*	in vicinity of Health Centre	parking on verge should continue to be allowed with possible changes to controls to accommodate this	Access & Availability of Space	Area wide
Ash	College Road*	outside Nos.35-41	parking in road, and opposite driveways, in narrow sections, causes issues, particularly in the evening and at weekends	Safety & Access	Area wide
Ash	College Road*	junction with Heathcote Road	parking in vicinity of junction causes issues	Safety & Access	Area wide
Ash	Elleray Court	adopted section	parking needs to be formalised	Safety, Access & Availability of Space	Area wide
Ash	Ewins Close*	parking close to bends and on pavements by lorries	wants restrictions and enforcement	Access & Availability of Space	Area wide
Ash	Gorselands Close		parking by non-residents causes access and availability issues. Residents want DYLS	Safety & Access	Local
Ash	Hutton Road*	in vicinity of The Swan public house	inconsiderate parking on associated with the pub on both sides of the road and on the bend causes issues	Safety & Access	Area wide
Ash	Longacre	various corners but junction with Church View in particular	inconsiderate parking on junctions and bends	Access & Availability of Space	Area wide
Ash	Longfield Road	private access road	wants restrictions to prevent obstruction of access	Safety & Access	Area wide
Ash	Potters Crescent	outside Nos.2-8	wants additional parking facilities created	Access & Availability of Space	Area wide
Ash	Potters Crescent	in vicinity and opposite No.13	wants parking restrictions introduced to improve access to and from off street parking facilities	Safety & Access	Area wide
Ash	Prospect Road*	various junctions including those with Gorseland Close and Elleray Court	concerns about parking in Prospect Road, particularly between 8pm and 8am the next day	Safety & Access	Area wide
Ash	Prospect Road*	between Nos.14-30 (brow of hill)	parking by residents near brow of hill causes issues	Safety & Access	Area wide
Ash	Prospect Road*	verges	inconsiderate parking on grass verges and speeding an issue	Access & Availability of Space	Area wide
Ash	Prospect Road*	outside Nos.52-56	vehicles sales on public highway cause issues	Safety & Access	Local

Non-CPZ List for Consideration - ANNEXE 3

Division(s) / Ward(s)	Road	Location	Issue / Request	Reason Given	Area-wide / Local
Ash	Shawfield Road	outside shops	long-stay parking affecting trade. Wants limited waiting controls, like those in nearby Wharf Road	Access & Availability of Space	Area wide
Ash	Shawfield Road	grass verge opposite shops	although subject to parking controls, parking on verge still causes issues	Environmental	Area wide
Ash	Vale Road	close to canal bridge	previously extended DYLS should be extended even further to prevent parking on western approach to bridge.	Safety	Area wide
Ash	Vale Road	close to canal bridge	Parking outside shop should be made limited waiting. Spaces occupied by local residents impacting business	Access & Availability of Space	Local
Ash	Wharf Road*	2007 restrictions	wants residents' parking scheme	Access & Availability of Space	Area wide
Ash	Wharf Road*	2007 restrictions	wants measures introduced to prevent double parking as present situation not obvious enough to motorists	Safety & Access	Area wide
Ash	Wharf Road*	in vicinity of Wollards Road	wants existing controls extended to improve visibility	Safety & Access	Area wide
Ash	Wren Court	junction with Fairview Road	inconsiderate parking blocks street nameplate and causes other difficulties, particularly for larger vehicles	Access & Availability of Space	Area wide
Ash Vale	Ash Close*	throughout close	parking on both sides of road, across driveways, close to junction and cul de sac cause issues	Safety & Access	Area wide
Ash Vale	Avondale (Ash Vale Railway Stn)	outside residents homes	since DYL added for cobbs garage they now park outside residents houses.	Access & Availability of Space	Area wide
Ash Vale	Beaufort Road	Beaufort Rd/old farm place	DYL req due to parking	Access & Availability of Space	Local
Ash Vale	Brook Close		Request resident parking or parking bay request - has autistic child and also damage from other residents if parks in front of houses	Safety & Access	Area wide
Ash Vale	Chart House Road	2007 restrictions	present restrictions are overly restrictive	Access & Availability of Space	Area wide
Ash Vale	Cody close	in/out drive	Parking restricts getting in/out driveway	Safety & Access	Local
Ash Vale	Fireacre Rd/Lysons Ave	fm Ashvale past Tesco + 300m on left	DYL req (fm Ashvale past Tesco + 300m on left) parked on both sides of the obekisk. Cars cause obstruction and hazard	Safety & Access	Area wide
Ash Vale	Foxhurst Road	corner & opp Foxhurst Rd	DYL req or parking controls. vehicles parked on corner obscuring traffic approaching. Ltd turn & visibility opp Foxhurst Rd .	Safety & Access	Area wide
Ash Vale	Frimley Road		Insufficient parking & if park in other streets, cars get damaged. Did request to GCC about permits	Safety & Access	Area wide
Ash Vale	Grove Road	exiting longmead onto Grove Road - Jnct Longmead	Exiting longmead onto Grove road is hazardous due to parked cars, due to reduced visibility	Safety & Access	Area wide
Ash Vale	Guildford Road*	Drive	Drive blocked & access difficult - dropped kerb legislation & possible lines required	Access & Availability of Space	Local
Ash Vale	Hillside Road	in/out drive	vans parked restrict pulling in/out of drive safely	Access & Availability of Space	Local
Ash Vale	Lakeside Road*		one property with 9 vehicles parks them indiscriminately on the footways and verges	Safety & Access	Area wide
Ash Vale	Lynchford Road	2007 restrictions	present restrictions are not restrictive enough and parking still causes issues	Safety & Access	Area wide
Ash Vale	Lysons Avenue*	by bollards	cars parked close to the bollards causing problems for other vehicles which are on the wrong side of road. Also damage to bollars and manner of driving for HGV	Safety & Access	Area wide

Non-CPZ List for Consideration - ANNEXE 3

Division(s) / Ward(s)	Road	Location	Issue / Request	Reason Given	Area-wide / Local
Ash Vale	Lysons Avenue*		DYL extention req & review of restrictions	Safety & Access	Local
Ash Vale	Mytchett Road	both sides	DYL were implemented taking away spaced for school drop off and pick up	Access & Availability of Space	Area wide
Ash Vale	Old Farm Place	various roads on estate	availability and allocation of space, parking on footways and close to accesses, particularly by larger vehicles, causes issues.	Access, Availability of Space & Environmental	Area wide
Ash Vale	Orchard Close	junction with Vale Road	large vehicle parked on grass verge close to junction causes issues.	Safety, Access & Environmental	Area wide
Ash Vale	Springfield Road		Having to park elsewhere due to congestion on parking, however cars getting damaged while parking elsewhere. Also cars for sale by garage contributing by parking on high way	Safety & Access	Area wide
Ash Vale	St Mary's Close		parking on grass verges causes various issues	Safety, Access & Environmental	Area wide
Ash Vale	Station Road West *	entrance or opp to business	DYL entrance as cars block pathway . Also some DYL gaps allow cars to park inbetween	Safety & Access	Area wide
Ash Vale	Station Road West *	close to pedestrian crossing	cant see down road at pedestrian crossing due to cars. DYL Req	Safety & Access	Area wide
Ash Vale	Stratford Road*	in vicinity of Holly Lodge school	parking during school run still causes issues despite introduction of 2012 controls. Need for controls to be extended / other measures to reduce impact of school.	Safety & Access	Area wide
Ash Vale	Vickers Road*	in vicinity of No.30	wants parking in vicinity and opposite access, often on the footway, prevented due to the issues it causes	Safety & Access	Area wide
Ash Vale	Warwick Road*	Throughout + outside 39	Dbl parking on paths & close to warwick Jnct, outside 39. Also complaint re planning outside 39 where parking is ltd already	Access & Availability of Space	Area wide
Ash Vale	Welleskey Close		DYL req	Access & Availability of Space	Local
Ash Vale	Wood Street	in vicinity of church	inconsiderate parking associated with church on pavements, on / close to driveways causes issues	Safety & Access	Area wide
Ash Wharf	Chester Road*		DYL request on blind bend prior to drive way & bend of chester rd also	Safety, Access & Traffic Flow	Area wide
Ash Wharf	Elm View*		DYL req as Kia Garage parking cars in residential car park, elm rd, no where for residents to park	Access & Availability of Space	Area wide
Ash Wharf	Wharf Road*	chandlers road health ctr	Parking Restriction or permits request to stop coaches as view obscured when pulling out chandlers road health ctr	Safety & Access	Local
Ash Wharf	Youngs Drive	pavement	DYL request	Access & Availability of Space	Local
Burpham	Bowers Lane	around junctions and on grass verges	Issues caused by parkings associated with nature area	Safety & Access	Area wide
Burpham	Bradfield Close		parking is becoming untenable	Safety, Access & Availability of Space	Area wide
Burpham	Darfield Road		inconsiderate parking causes issues	Safety & Access	Area wide
Burpham	Howard Ridge	school & yellow line down 1 side	unhappy that single line down 1 side leaving no parking for residents Also why parking round school so lenient	Access & Availability of Space	Area wide
Burpham	Kingpost Parade		Resident parking request as all parking charged	Access & Availability of Space	Area wide
Burpham	London Road *	214a	Request Resident Parking Scheme	Access & Availability of Space	Area wide
Burpham	London Road *		inconsiderate parking outside 232 causes problem with line of site when trying to join traffic. One car occupies the single space and cars park right up to it	Safety & Access	Local
Burpham	London Road *		Cars double parking in parking bay (non residents) causing obstruction and impair vision when pulling out of drive. Either Dbl Yellow or time limit in Bay.	Safety & Access	Area wide

Non-CPZ List for Consideration - ANNEXE 3

Division(s) / Ward(s)	Road	Location	Issue / Request	Reason Given	Area-wide / Local
Burpham	London Road *		Parked cars opposite drive make it difficult to get in/out. Yellow Lines?	Safety & Access	Area wide
Burpham	London Road*		parking in lay-by restricts visibility and causes access issues.	Safety & Access	Area wide
Burpham	Weybrook Drive	pavement parking	wants issues it poses to pedestrians resolved	Safety & Access	Area wide
Burpham	Weylea Avenue, Weylea Farm	when enter from A3100	Due to legal parking on left people entering from A3100 have to drive on wrong side of road, from other way enter on blind bend and met by vehicles on their side. Also close to school	Safety & Access	Area wide
Burpham	Woodruff Avenue	near George Abbot School, where it becomes Charlock Way	to improve access for coaches wants parking restricted	Safety & Access	Area wide
Burpham	Bowers Farm Drive		DYL req, Unbroken lengths of parking on one side of road	Access & Availability of Space	Area wide
Burpham	Winterhill Way	between Briar Way and Hawthorn Way	parking close to junctions and opposite bus stop	Safety	Area wide
Chilworth	Brookwood Road	either side missed	DYL request , this road missed when side roads has YL implemented. Parking on dropped kerbs and visibility problems. Sunday worst day	Safety & Access	Area wide
Christchurch	Beatty Avenue	vicinity of school	Existing restrictions need extending significantly to resolve issues with blocking drives & crossovers during school runs	Safety & Access	Area wide
Christchurch	Boxgrove Avenue	at junctions with London Road (near Eaton Court) and Boxgrove Road	inconsiderate parking too close to junctions, accesses and on footways by residents of Eaton Court spills over into Boxgrove Avenue, and office parking at Boxgrove Road end of road also causes issues.	Safety & Access	Area wide
Effingham	Lower Road*	Howard effington sch & brow of hill	since DYL introduced parking issue has moved to brow of hill & build up of traffic	Safety & Access	Area wide
Effingham	Mount Pleasant*	sharp bend & both sides	existing DYLS need to be extended to resolve issues caused by rugby club at weekends	Safety & Access	Area wide
Effingham	Northcote Road		DYL removal request as no where to park for residents	Revision to controls	Area wide
Effingham	Norwood Road*	near junction with Epsom Road	want extension to existing controls. Extend lines towards Norwood close	Safety & Access	Area wide
Friary & St Nicolas	Artillery Terrace	outside 31	Disabled Bay Request	Access & Availability of Space	Local
Friary & St Nicolas	Queens Place	O&S Committee	O&S Committee - New residents looking for permits	Access & Availability of Space	Local
Holy Trinity	Downside Road	in vicinity of school sports facility (Urnfield)	residents parking inconsiderately and threatening users of the school facilities	Safety, Access & Availability of Space	Area wide
Horsley	Bishopsmead Parade	limited waiting bays	2-hour limit is too short for visitors to hairdresser. Wants longer period or permit scheme	Access & Availability of Space	Area wide
Horsley	Effington Jnct Train Station	access to Howard Road	Cars parked on DYL blocking access to Howard Road.	Safety & Access	Area wide
Horsley	Epsom Road (A246)	pavement parking in vicinity of Carlans Garage	wants measures to prevent footway parking	Safety & Access	Area wide
Horsley	Farleys Close		inconsiderate parking by residents on footways and verges cause issues. Measures required to prevent this.	Safety & Access	Area wide
Horsley	Forest Road	Effingham jnct end. Verge side of service road at jnct	cars parked on verge side of service road at jnct, causings issues for residents an damage to verge & hazard to children	Safety & Access	Area wide
Horsley	Kingston Avenue*	o/s Nos.1&2	advises houses have been extended and it means cars repeatedly park so that they block the footway and access completely	Safety & Access	Area wide
Horsley	Kingston Avenue*	outside No.47	wants formalised controls to prevent vehicles blocking driveway	Access & Availability of Space	Area wide

Non-CPZ List for Consideration - ANNEXE 3

Division(s) / Ward(s)	Road	Location	Issue / Request	Reason Given	Area-wide / Local
Horsley	Kingston Avenue*		Parking restriction request. Tiny space btw 47+48 on;y big enough for smart car, also road and driveways being blocked inc large vehcles for days	Access & Availability of Space	Area wide
Horsley	Nightingale Crescent (GBC) and Northcote Crescent*	in vicinity of Raleigh School and on bend near 'Fariwinds' in particular	parking associated with school run causes issues which need to be addressed	Safety & Access	Area wide
Horsley	Ockham Road South	outside Maranello House	wants SYL changed to DYL to deter lorry parking on pavements	Safety & Access	Local
Horsley	Ockham Road South	layby opposite F Connisbee & sons	Commuters park in layby therefore no space for customers who visit, also if can park sometimes have to reverse into on coming traffic, want 1 hr restriction	Safety & Access	Local
Horsley	School Lane*	junctions with Overbrook and The Street	parking close to junctions causes safety and access issues. DYL request	Safety & Access	Area wide
Horsley	St Martins Close*		inconsiderate parking by commuters and other non-residents throughout road, but particularly close to junction with Ockham Road South, on bend and adjacent to lowered kerbs cause issues, including ones of availability of space.	Safety, Access & Availability of Space	Area wide
Horsley	The Street*	in the vicinity of Village Hall and School	inconsiderate parking associated with both cause access issues for residents esp new owner to motor co parking cars on road, hazard	Safety & Access	Area wide
Horsley	Various East Horsley	existing restrictions	following PCN suggested parking restrictions are not required in a village such as East Horsley	Access & Availability of Space	Area wide
Lovelace	High Street, Ripley*	bus stops	complaint about parking in bus stops which presently are not clearways due to lack of signs. Also question about controls due to access problems	Safety & Access	Area wide
Lovelace	High Street, Ripley*	service road outside Hartley Antiques and other verges	concern about loss of space if parking is prevented in service road and on other verges	Access & Availability of Space	Area wide
Lovelace	High Street, Ripley*	service road outside Hartley Antiques	wants parking on services road and adjacent grass verge prevented	Safety & Access	Area wide
Lovelace	Newark Lane / Georgelands, Ripley *	jnct	parking at jnct blocks view to bend & long stay parking problem	Safety & Access	Area wide
Lovelace	Newark Lane / Georgelands, Ripley *	entrance to Georgelands onto Newark Lane	Signage change request, reposition sign	Safety & Environmental	Local
Lovelace	Portsmouth Road	grassed areas in vicinity of Sevenoaks	HGVs park on the verges causing damage. Wants reinstatement of physical measures.	Safety, Access & Environmental	Area wide
Lovelace	Underwood Avenue		Parking congestion, suggest convert grass verge to parking	Access & Availability of Space	Area wide
Lovelace	Vale Road*	jnct & vale Rd	Reported white van causing obstruction, blocking jnct . Parking restriction request on vale road due to congestion	Safety & Environmental	Area wide
Lovelace	Woking Road*	jnct & bypass	DYL request due to workers parking near jnct, causing hazard	Safety & Access	Area wide
Lovelace	Woodlands Road*		Parking restriction request due to problems for disabled 86 year old to leave house	Safety & Access	Area wide
Lovelace	Woodside Road*	26 Woodside & 57 Woodwise	(26) ask for ext of line but since harrasement and blocking access need help to work out solution & (57) Cars park outside or opposite my drive making if difficult for me to get in/out. There are dbl yellow lines which stop at my drive, can they be continued . DYL REV	Safety & Access	Local
Merrow	Ashbury Crescent*		inconsiderate parking by residents causes issues and needs addressing	Safety & Access	Area wide
Merrow	Collingwood Cresent		C/O AH - Parking restriction req	Access & Availability of Space	Area wide
Merrow	Daryngton Drive*		parking on verges and close to junctions and points of access cause issues . There is a need for residents' parking	Safety & Access	Area wide
Merrow	Daryngton Drive*	various junctions within	wants yellow lines at its junctions with Epsom Road, Carroll and Elles	Safety & Access	Area wide
Merrow	Down Road*	parking issues throughout road	need for residents' parking scheme to resolve availability issues, believed (by residents) to be caused by non-residents.	Access & Availability of Space	Area wide

Non-CPZ List for Consideration - ANNEXE 3

Division(s) / Ward(s)	Road	Location	Issue / Request	Reason Given	Area-wide / Local
Merrow	Duncan Drive	Obstruction at 3	Large vehicle parks on road rather driveway outside 3, causing obstruction for cars turning left into DD, forced to swerve into middle of road /blind bend - hazard	Safety & Access	Area wide
Merrow	Epsom Road	near Boxgrove Gardens	parking on verge causing damage	Environmental	Area wide
Merrow	Fitzjohn Close		Parking restrictions required as cars parking on pavements & parking blocking access to road	Safety & Access	Area wide
Merrow	Great Goodwin Drive*	junction with Long Dyke	parking on verge causing damage	Environmental	Area wide
Merrow	Greencroft		supporting various parking challenges	Safety & Access	Area wide
Merrow	Greenhill Gardens		Congestion due to non residents, or use for free park and ride, some vans take up two residents spaces. Some large delivery vehicles not able to get through, wants sign to say resident parking	Safety & Access	Area wide
Merrow	Grove Road		parking too close to junction	Safety & Access	Area wide
Merrow	High Path Road*		Unrestricted parking, without breaks for passing, causes various issues. Parking is impossible day or night. The golf club at end and shops at entrance don't assist. Wants residents' parking	Safety, Access & Availability of Space	Area wide
Merrow	Holford Road	near junction with Epsom Road	parking close to junction causes safety and access issues	Safety & Access	Area wide
Merrow	Kingfisher Court	turning area outside Merrow Infant School	issues with parking during school run, and more generally, how the 'roundabout' is interpreted by motorists	Safety & Access	Area wide
Merrow	Kingfisher Drive*	junction with Harewood Road	parked vehicles cause those approaching junction to do so on wrong side of road	Safety & Access	Area wide
Merrow	Kingfisher Drive*	between Merrow Street and Collier Way	additional restrictions required to prevent all parking in this area	Safety & Access	Area wide
Merrow	Kingfisher Drive*	front of school	cars park at front as no controls + raised area turning circle that is being parked on	Safety & Access	Area wide
Merrow	Laustan Close	in vicinity of Church	inconsiderate parking associated with church causes issues.	Safety & Access	Area wide
Merrow	Levyldene	green near junction with Epsom Road	commercial vehicles associated with building work causing issues and nuisance	Safety, Access & Environmental	Area wide
Merrow	Levyldene*		DYL Req due to cars blocking driveways and near misses	Safety & Access	Local
Merrow	Levyldene*		inconsiderate parking need enforcement & restrictions	Access & Availability of Space	Area wide
Merrow	Martins Close	pavement parking	commercial vehicles cause issues for access and potentially damage to footways. Wants bollards put back	Safety, Access & Environmental	Area wide
Merrow	Merrow Common Road	exit from R/B at Park in/Merrow In	always 12-15 cars parked on first 2 bends , make visibility and blind bend	Safety & Access	Area wide
Merrow	Merrow Street*	near junction with Epsom Road, allotments and Sadlers Close & corner of	Parking close to junctions and points of access causes issues. After DYL introduced now park between short lines corner of A25. continue DYL to sadler close	Safety & Access	Area wide
Merrow	Parklands Place	footways, driveways, cul de sac	inconsiderate parking on footways and adjacent to accesses causes issues & cul de sav. Request for controls, yellow lines or H bars?	Safety & Access	Area wide
Merrow	Sheeplands Avenue	opposite No.37	wants restrictions introduced to prevent parking opposite driveway	Access & Availability of Space	Area wide
Merrow	Speedwell Close	jnct btwn speedwell cl & Ashbury Cres, on corner + up hill	DYL req, Vehicles parked on corners leaves blind spot, parked cars up hill on leave room for 1 vehicle to pass	Safety & Access	Area wide
Merrow	Stonecrop Road & Vicinity		concerned about availability of parking	Access & Availability of Space	Area wide

Non-CPZ List for Consideration - ANNEXE 3

Division(s) / Ward(s)	Road	Location	Issue / Request	Reason Given	Area-wide / Local
Merrow	Trodds Lane	pinch points	Yellow line restrictions around pinch points to prevent undue effect on parking issues with visibility and traffic flow	Safety, Access & Traffic Flow	Local
Merrow	Tychbourne Drive	bays outside 56-62	bays 56-62 are misused by 1 resident. Parks between bays and at angles to hard to park	Access & Availability of Space	Area wide
Merrow	Wykeham Road		parking issues	Safety & Access	Area wide
Merrow*	Hareward Road	Hareward road adj Ashbury Cresnet	Unbroken lengths of parking on bend	Safety	Area wide
Normandy	Glaziers Lane	near church	a car regularly parks inconsiderately on footway	Safety & Access	Area wide
Normandy	The paddock		since Stn charged for parking commuters using the paddock to park causing problem for residents. Also danger to veh coming in/out. Could a time limit be put on parking to help	Safety & Access	Area wide
Onslow	Ash Grove / Cathedral Hill	opp side to houses	snl yellow line req opposite houses	Access & Availability of Space	Area wide
Onslow	Beech Grove*	opposite No.61 and elsewhere	due to availability of space it is necessary for residents to park on grass verges	Access & Availability of Space	Area wide
Onslow	Beech Grove*	eastern cul-de-sac end	inconsiderate parking on both sides of road, including on verges, and also in vicinity of The Drive, causes issues and prevents access by larger vehicles	Safety & Access	Area wide
Onslow	Cherry Tree Avenue*		inconsiderate parking on both sides of road, including on verges, across driveways causes issues and prevents access by larger vehicles	Safety & Access	Area wide
Onslow	Egerton Road* / (North-South Section)	SYL peak time restriction	SYL restrictions should be removed to allow parking at all times. Need for improved hospital parking. Parking should be prioritised for residents and blue badge holders.	Access & Availability of Space	Area wide
Onslow	Egerton Road* / (North-South Section)	btwn cathederal & tesco RB & before A3	Prk btwn cathederal + Tesco r/b causing obstruction in morning rush & More cars parked edgerton rd after the cathederak RB beore A3 causing congestion	Safety & Access	Area wide
Onslow	Middleton Road / Egerton Rd	cathederal end before A3 bridge	cars started to use Middleton Rd as free parking (from uni) & if left could encourage more. Catheder end b4 A3 bridge	Access & Availability of Space	Area wide
Onslow	Middleton Road Industrial Estate		existing restrictions are outdated and parking needs to be reintroduced	Access & Availability of Space	Area wide
Onslow	various Ashenden Estate	verges and footways	vehicles double parked on verges and footways cause issues for pedestrians. Need for residents' parking if measures are introduced to resolve this.	Safety, Access & Availability of Space	Area wide
Peaslake	Ewhurst Road		Can't park close to homes due to congestion from non residents	Access & Availability of Space	Area wide
Peasmarsh	Oakdene Place	leaving oakdene place	DYL req to alleviate problems leaving place as vehicles parked causing visibility problems	Safety & Access	Area wide
Pirbright	Avenue de Cagny car park		Comuter and all day parking causes issues for residents, visitors and customers	Access & Availability of Space	Area wide
Pirbright	Church Lane	around The Little Green	Comuter and all day parking causes issues for residents, visitors and customers & damage tpo grass verges	Access, Availability of Space & Environmental	Area wide
Pirbright	Church Lane, Albury	junction with Weston Fields	parking on verge causing damage, and elsewhere, limiting availability	Access, Availability of Space & Environmental	Area wide
Pirbright	Fairlands Avenue*	Svc rd	DYL Req for greater protection for 32 and neighbour & also question if some of pavement could be made into parking	Access & Availability of Space	Area wide
Pirbright	Louis Fields, Fairlands*	verge	verge parking by non residents	Safety & Access	Area wide
Pirbright	Mill Lane*	from A324 Guildford Road to Rapley's Field	Comuter and all day parking causes issues for residents, visitors and customers. Resident parking	Access & Availability of Space	Area wide
Pirbright	Pincott Lane*	junctions with The Street	parking close to junctions causes safety and access issues. DYL request	Safety & Access	Area wide

Non-CPZ List for Consideration - ANNEXE 3

Division(s) / Ward(s)	Road	Location	Issue / Request	Reason Given	Area-wide / Local
Pirbright	Pirbright village car park	pirbright village parking	Commuters from Stn leaving cars in car parks reducing space for residents and village users. Can time restrictions be added to avoid all day commuters	Access & Availability of Space	Area wide
Pirbright	The Gardens*	turning circle	since restrictions added, commuter parking worse on green, residents can not park and turning circle is congested. Problem for emergency services	Safety & Access	Area wide
Pirbright	White Hart Corner	lay-bys next to village green	Comuter and all day parking causes issues for residents, visitors and customers	Access & Availability of Space	Area wide
seale	Manor Fields		Resident parking request	Access & Availability of Space	Area wide
Shalford / Ash South & Tongham	Almsgate	in vicinity of No.1	inconsiderate parking on grass verges and footways.	Safety & Access	Area wide
Shalford / Ash South & Tongham	Ash Green Road*	Bend - direction of white lane	parking on bend causes issues, hazard pushing vehicles into oncoming traffic (along Ash green in direction of White Lane)	Safety	Area wide
Shalford / Ash South & Tongham	Ash Street		Move Bay to left of 67, back one space to allow visibility, 4 accidents since bay introduced	Safety & Access	Local
Shalford / Ash South & Tongham	Cardinals Estate (East Ring)*	in vicinity of schools, children's daycare centre and old peoples' home	parking on junctions, pavements and across lowered kerbs causes safety and access issues, particularly during school run. Increased parking provision required and yellow line waiting restrictions.	Safety, Access & Availability of Space	Area wide
Shalford / Ash South & Tongham	Cardinals Estate (East Ring)*	in vicinity of No.22	Wants restriction around and opposite driveway to facilitate access for his large, disabled-adapted vehicle	Access & Availability of Space	Area wide
Shalford / Ash South & Tongham	Carfax Avenue		Parking on footpaths a problem. Verge parking would be beneficial	Safety, Access, Availability of Space & Environmental	Area wide
Shalford / Ash South & Tongham	Carfax Avenue		wants parking bays and parking controls to be introduced	Safety, Access & Availability of Space	Area wide
Shalford / Ash South & Tongham	Carfax Avenue	opposite driveway	registered disabled and has 18ft long vehicle that has difficulty accessing off-street facilities when vehicles parked opposite.	Access & Availability of Space	Area wide
Shalford / Ash South & Tongham	Carfax Avenue		availability of space issues.	Access & Availability of Space	Area wide
Shalford / Ash South & Tongham	Chinthurst Lane	near granary cottage	HGV mount pavement near granary cottage, hazard to pedestrians - since controls put in place	Safety & Access	Area wide
Shalford / Ash South & Tongham	Copse Close		Signage request for resident parking only, now new road non residents parking on Copse Close	Access & Availability of Space	Area wide
Shalford / Ash South & Tongham	Farm Walk*	in turning head	Resident has turning circle outside house which gets congested and difficult for refuse/emergency vehicles. Also asks about DISABLED bay requirement	Safety & Access	Area wide
Shalford / Ash South & Tongham	Foreman Park	2012 restrictions	parking on estate already chaotic and likely to be exacerbated by new controls to be introduced nearby.	Safety, Access & Availability of Space	Area wide
Shalford / Ash South & Tongham	Foreman Road	2012 restrictions	Parking should be prevented between Ash Church Road and Foreman Park and beyond.	Safety & Access	Area wide
Shalford / Ash South & Tongham	Foreman Road*	exit of Foreman RD & Rd leading to STN	Exit of Foreman Road obscured by parked cars from the stn, when pull out blind bend. Request for DYL down both sides	Safety & Access	Area wide
Shalford / Ash South & Tongham	Grange Road*	both sides of road beyond existing restrictions	wants additional controls to prevent parking obstructing deliveries by large vehicles & on Verges	Access & Availability of Space	Area wide
Shalford / Ash South & Tongham	Harpers Road	Near junction with Guildford Road (Class A)	parking close to junction causes issues both within Harpers Road and Guildford Road & on grass verge obstructing view	Safety & Access	Area wide
Shalford / Ash South & Tongham	James Road jnct Oakdene Road	up to jnct	vehicles park right up to the jnct, restrict view and danger to cyclist + kids playground opposite so attracts kids	Safety & Access	Area wide

Non-CPZ List for Consideration - ANNEXE 3

Division(s) / Ward(s)	Road	Location	Issue / Request	Reason Given	Area-wide / Local
Shalford / Ash South & Tongham	Kings Road		Legal parking bays are obstructing safe exit from Station Rd as on bend, causing hazard pulling out. Suggestion to move to side of village green along Kings Road.	Safety & Access	Area wide
Shalford / Ash South & Tongham	Kings Road*	outside snooty fox	Lack of parking for shops/café create parking problems esp when deliveries. Cars parked to the side causing bank erosion. Illegal parking is happening. Could customer parking be created either where the bank is or in the the field used by fairground.	Safety, Access & Environmental	Area wide
Shalford / Ash South & Tongham	Manor Road	near Ash Manor School	Damage caused to grass verges by parents involved in school run.	Environmental	Area wide
Shalford / Ash South & Tongham	May Crescent		insufficient parking for residents leading to inconsiderate parking. More parking required.	Safety, Access & Availability of Space	Area wide
Shalford / Ash South & Tongham	New Road, Chilworth*	further to 2012 controls	Further request from Police and a local resident for additional controls in various locations	Safety & Access	Area wide
Shalford / Ash South & Tongham	Newton Way		motorists encroach upon lowered kerb and park opposite making access difficult	Access & Availability of Space	Local
Shalford / Ash South & Tongham	Oakdene Road*	Various including accesses to James Road and Oakdene Place	all day parking associated with Astolat industrial estate (particularly the Renault garage) causes issues. Could the grass verge be engineered to create more parking. Residents of road are using cones, boxes and other items to sequestrate public highway for their own use	Safety, Access, Availability of Space & Environmental	Area wide
Shalford / Ash South & Tongham	Oxenden Road	opposite Phillips Close	wants restrictions to prevent parking on verge which blocks pedestrian link through to footway	Safety & Access	Area wide
Shalford / Ash South & Tongham	Poplar Road	outside No.35 on bend	parking by residents of No.35 causes issues	Safety & Access	Local
Shalford / Ash South & Tongham	Poyle Road	outside church	DYL to priorities space outside the church for weddings and hearses. SCC already proposing to introduce a carriage way edge marking as a stop gap	Availability of Space	Local
Shalford / Ash South & Tongham	Shawfield Lane	in vicinity of junction with Shawfield Road	inconsiderate parking close to driveway and junction cause issues.	Safety & Access	Area wide
Shalford / Ash South & Tongham	Spiceall	disabled bay outside No.33	needs to be formalised to deter abuse	Access & Availability of Space	Area wide
Shalford / Ash South & Tongham	Spoil Lane	near junction with Manor Road	parking associated with Vets causes issues	Safety & Access	Local
Shalford / Ash South & Tongham	Station Road*		congestion since new housing dev, require resident parking, vouchers, permit DYL, remove pathway to create parking	Access & Availability of Space	Area wide
Shalford / Ash South & Tongham	The Ridges		inconsiderate parking associated with Mount Brown Police HQ causes issues.	Safety & Access	Area wide
Shalford / Ash South & Tongham	The Street, Puttenham	in vicinity of Good Intent public house	parking associated with pub coupled with lorries wishing to gain access to nearby ind. est. causes issues	Safety & Access	Area wide
Shalford / Ash South & Tongham	The Street, Tongham*	in vicinity of No.20	inconsiderate parking on pavements and opposite driveways cause issues	Safety & Access	Area wide
Shalford / Ash South & Tongham	The Street, Tongham*	between Grange Road and give way 'feature'	parking combined with the volume of vehicles using the road causes issues	Safety, Access & Availability of Space	Area wide
Shalford / Ash South & Tongham	Underwood Avenue	junction with Roberston Way	parking close to junction causes safety and access issues	Safety & Access	Area wide
Shalford / Ash South & Tongham	Underwood Avenue	in vicinity of St Georges Stores	inconsiderate parking on grass verges and footways causing issues.	Safety, Access & Environmental	Area wide
Shalford / Ash South & Tongham	Underwood Avenue		levels of car ownership amongst some residents, and those having building works done, causes issues for other residents.	Safety, Access & Environmental	Area wide
Shalford / Ash South & Tongham	various roads within Compton		wants DYLs to prevent ongoing obstruction of driveway issues	Safety & Access	Local

Non-CPZ List for Consideration - ANNEXE 3

Division(s) / Ward(s)	Road	Location	Issue / Request	Reason Given	Area-wide / Local
Shalford / The Pilgrims	The Green, Seale	in vicinity of The Sands Room	parking associated with club causes severe access issues and impacts on availability of space	Safety, Access & Availability of Space	Local
Shere	Lime Grove / Woodstock*	at junction	wants restrictions to prevent parking close to junction	Safety & Access	Area wide
Shere	Meadowlands*		parking in laybys by rail commuters at West Clandon railway station by day and within the carriageway by residents in the evening is causing issues	Safety, Access, Availability of Space & Environmental	Area wide
Shere	Meadowlands*	opposite Nos.41-43	Verges are damaged, unsightly and could be used to create additional parking	Availability of Space & Environmental	Area wide
Shere	Send Barns Lane*	west side of road, 27-29	DYL req to west side of road outside 28,29 and up to end of lowered kerb outside 27 to improve line of sight	Safety & Access	Area wide
Shere	The Street (A247), West Clandon	in vicinity of school	enforceable parking controls required to resolve issues caused by the school run	Safety & Access	Area wide
Shere	Beech Drive, Send		inconsiderate parking outside properties and close to driveways	Access & Environmental	Area wide
Shere / Send	Maple Road	in vicinity of junction with Send Marsh Lane	parking close to junction causes issues	Safety & Access	Area wide
Shere / Send	Maysfield Close	parking by non-residents	wants residents' only parking scheme for residents of Maysfield Road, and 6 & 7 Send Marsh Road to prevent parking by other residents who live nearby	Access & Availability of Space	Area wide
Shere / Send	Portsmouth Road (B2215), Send	to right of junction with Broughton Hall Avenue	parking in vicinity of junction and in bus stop needs to be prevented	Safety & Access	Area wide
Shere / Send	Potters Lane	in vicinity of New Inn public house	footway parking causes safety and access issues	Safety & Access	Local
Shere / Send	Sandfields	junction with Send Hill	inconsiderate parking associated with school run causes issues. Would like restrictions associated with the times of the school run	Safety & Access	Local
Shere / Send	Send Hill*	around Rec.	Would prefer not to have formalised controls but inconsiderate parking adjacent to and opposite drive associated with Rec. causes issues.	Safety & Access	Local
Shere / Send	Send Hill*	in vicinity of Sandilands	inconsiderate parking close to driveway cause issues.	Access & Availability of Space	Local
Shere / Send	Send Hill*	around St Bede's School	problems associated with school run need to be addressed by DYL on both sides of road. Cars parked on pavement	Safety & Access	Area wide
Shere / Send	Send Hill*	Nos.157-160	inconsiderate parking associated with nearby shops and café causes issues for bin collections	Safety & Access	Area wide
Shere / Send	Send Hill*	Nos.108-110	parking on footways causes issues for pedestrians and restricts visibility for those using access between Nos.108-100	Safety & Access	Area wide
Shere / Send	Send Hill*	in vicinity of Village Medical Centre	want additional posts (or the like) to the east of the entrance, to prevent parking.	Safety & Access	Local
Shere / Send	Wharf Lane*	parking close to junctions	inconsiderate parking causes issues and particular residents who run business regularly block road with vans	Safety & Access	Area wide
Shere / Tillingbourne	Felday Glade, Holmbury St Mary	opposite Glade House and at junction with B2126	wants restrictions opposite driveway to facilitate visits by fuel lorries and at junction to improve safety	Access & Availability of Space	Local
Shere / Tillingbourne	Halfpenny Close	close to junction with Blacksmith Lane	wants restrictions to prevent parking by commercial vehicles, particularly on footways	Safety, Access & Environmental	Area wide
Shere / Tillingbourne	Middle Street	next to Co-op	continuing concerns about issues caused by convenience store, and particularly deliveries.	Safety & Access	Local
Shere / Tillingbourne	New Road, Gomshall	junction with Queen Street	parking close to junctions causes safety and access issues, particularly for refuse vehicles	Safety & Access	Area wide

Non-CPZ List for Consideration - ANNEXE 3

Division(s) / Ward(s)	Road	Location	Issue / Request	Reason Given	Area-wide / Local
Shere / Tillingbourne	Pathfields*	in vicinity of junctions	concerns about lack of parking for residents forcing them to park in dangerous locations. Wants parking issues addresses and car park for residents	Safety, Access & Availability of Space	Area wide
Shere / Tillingbourne	Shere Lane*	between Pathfields and Pilgrims Way and cycle shop	inconsiderate parking including on footways causes serious safety issues. Want DYLS.	Safety & Access	Area wide
Shere / Tillingbourne	Station Road (A25), Gomshall*	pavement parking near Murco garage	wants issues it poses to pedestrians resolved	Safety & Access	Area wide
Shere / Tillingbourne	Station Road (A25), Gomshall*	outside Council Offices (Tanyard Hall)	inconsiderate parking on blind bend, partly on footway at night, primarily by residents of Tannery Cottages.	Safety & Access	Area wide
Shere / Tillingbourne	Upper Street	in vicinity of and opposite Pilgrims Garth	wants parking prevented in vicinity of access and on pavements	Safety & Access	Area wide
Stoke	(Old) Woking Road*	between Red Rose Indian Restaurant to cul-de-sac end	inconsiderate parking causes issues, particularly in vicinity of acces to Stoke Mills Court	Access & Availability of Space	Area wide
Stoke	Cedar Way	junction and pavements, particularly in vicinity of Birch Grove	parking in the junction and on the pavements causes issues	Safety & Access	Area wide
Stoke	Cypress Road	in vicinity of No.68 and elsewhere	parking outside and opposite property causes issues, particularly as it's on a bus route.	Safety & Access	local
Stoke	Groom Walk	2011 restrictions	wants measures to overcome issues caused by overflow associated with neighbouring Slyfield Industrial Estate	Safety, Access & Availability of Space	Area wide
Stoke	Hazel Avenue*	in vicinity of children's centre and new school development	concerned about all day parking associated with expanded uses of schools, and during school run in particular, when parents of children add to issues. Wants restrictions around junctions and to prevent issues close to bus stops.	Safety & Access	Area wide
Stoke	Hornbeam Road	outside No.3	wants formalised controls to prevent vehicles blocking driveway	Access & Availability of Space	Area wide
Stoke	May Tree Close		parking on verges, particularly by commercial vehicles, churning up green and causing issues	Availability of Space & Environmental	Area wide
Stoke	Medlar Close*		cars obstructing dropped kerb	Safety & Access	Local
Stoke	Moorfield road		Additional parking bays requested for people working on estate. Lack of space esp as HGV now parking up	Access & Availability of Space	Area wide
Stoke	Old Farm Road	opposite bus stop o/s Nos.103-105	parking opposite bus stop causes issues when bus uses stop.	Safety & Access	Local
Stoke	Rowan Close		inconsiderate parking and availability issues caused by residents, which are only likely to be exacerbated by proposed housing developments	Access & Availability of Space	Area wide
Stoke	Slyfield Green*		wants parking by commuters prevented, preferring a solution to be found on the Slyfield Industrial Estate	Access & Availability of Space	Area wide
Stoke	Stoughton Road	verges in vicinity of Forsythia Place	parking on grass verges by residents and their visitors causes damage	Environmental	Local
Stoke	various	in vicinity of Weyfield School	parking associated with school run causes issues which need to be addressed	Safety & Access	Area wide
Stoke	various on Slyfield Industrial Estate*		loss of parking due to parking controls introduced in 2011 and 'mis-use' of lay-bys	Access & Availability of Space	Area wide
Stoke	various on Slyfield Industrial Estate*	parking bays	nuisance overnight parking causes issues and security concerns	Environmental	Area wide
Stoke	Westfield Road*	in vicinity of VW garage	double parking adjacent to lay-by causes issues as does long-stay parking by certain businesses	Safety & Access	Local
Stoke	Westfield Road*	in vicinity of 21/23 Westfield Road	revised access arrangements for 21/23 Westfield Road proposed and need to be accommodated	Access & Availability of Space	Local

Non-CPZ List for Consideration - ANNEXE 3

Division(s) / Ward(s)	Road	Location	Issue / Request	Reason Given	Area-wide / Local
Stoke	Weyside Road*	at junction with Stoughton Road and in turning circle	inconsiderate parking by residents and visitors cause issues at all times	Safety & Access	Area wide
Stoke	Whitemore Road		Yellow lines and/or resident parking due to non resident parking concerns & impact on accessibility & available spaces.	Access & Availability of Space	Area wide
Stoke	Woodlands Road*	2011 restrictions	now wants residents' parking scheme to resolve issues caused by neighbouring Slyfield Industrial Estate	Safety, Access & Availability of Space	Area wide
Stoke	Woodlands Road*	verges	parking on grass verges by residents causes damage	Environmental	Area wide
Stoke	Woodlands Road*	outside & opposite No.38	inconsiderate parking by abattoir workers cause issues	Safety & Access	Local
Stoke	Woodlands Road*		overnight parking by HGVs cause issue for residents.	Environmental	Local
Stoughton	Stoughton Road*	most of Bellfields & Woodbridge Hill	action required to deal with pavement parking & obstructing dropped kerbs	Safety & Access	Area wide
Stoughton	Anderson Close	in vicinity of accesses to communal parking areas	inconsiderate parking close to accesses cause issues although would prefer mirrors	Safety & Access	Local
Stoughton	Ardmore Avenue*		measures needed to increase availability of parking and prevent inconsiderate parking	Safety, Access & Availability of Space	Area wide
Stoughton	Ardmore Road		Resident parking request	Access & Availability of Space	Local
Stoughton	Badger Close*		DYL req to stop obstructions in street	Safety, Access & Environmental	Area wide
Stoughton	Barack Road	entrance behind sutton court	o/s entrance to garages behind sutton court	Safety & Access	Local
Stoughton	Barack Road*		parking associated with evening economy and new residential development causes issues for other residents.	Access & Availability of Space	Area wide
Stoughton	Barack Road*	in vicinity of Raywood Court	inconsiderate parking in and around access causes issues.	Access & Availability of Space	Area wide
Stoughton	Barack Road*	junction with Worplesdon Road	parking on bellmouth of junction and across pedestrian crossover cause issues	Safety & Access	Area wide
Stoughton	Byrefield Road		Cars parked on DYL as faded on corner & obstructing traffic. DYL need re-doing	Safety & Access	Area wide
Stoughton	Cardamon Close		Can visitor bay be changed to disabled bay to allow wheelchair access	Access & Availability of Space	Local
Stoughton	Deeprose Close	junction with Grange Road	inconsiderate parking , particularly that associated with use of playing fields causes issues.	Safety & Access	Area wide
Stoughton	Grange Road*	north of junction with Harts Gardens o/s No.101	wants DYLs amended (shortened or lengthend) to stop issues caused by vehicles trying to park between junction and access	Access & Availability of Space	Area wide
Stoughton	Grange Road*	outside terraced properties	neighbourhood disputes over availability of parking within space remaining as a result of 2011 controls	Access & Availability of Space	Area wide
Stoughton	Johnston Green	area in front of garage block (public highway)	parking opposite garages causes issues	Access & Availability of Space	Area wide
Stoughton	Johnston Walk	Junction with Worplesdon Road (service road)	Junction with Worplesdon Road (service road)	Safety & Access	Area wide
Stoughton	Johnston Walk		inconsiderate parking on footways causes issues	Safety & Access	Area wide
Stoughton	Johnston Walk*	bend & approach	large vehicles park on bend causing drivers to pass on opp side. Parking is restricted due to large tree & visibility. Other end of JW approach with Johnston grnd & Tylehost, also cause hazard	Safety & Access	Area wide

Non-CPZ List for Consideration - ANNEXE 3

Division(s) / Ward(s)	Road	Location	Issue / Request	Reason Given	Area-wide / Local
Stoughton	Larch Avenue	btwn mni R/B with Larch Ave & Hornbeam Rd	Vehicles double parked down both sides of Stoughton rd between points mentioned. It is dangerous & poor visibility	Safety & Access	Area wide
Stoughton	Manor Gardens*	pavement parking	action required to deal with pavement parking and access issues, particularly for those wishing to use the footways and recycling vehicles	Safety & Access	Area wide
Stoughton	Manor Road*	parking bays	spaces being misused by Home2School minibuses	Access & Availability of Space	Area wide
Stoughton	Manor Road*	opposite and in vicinity of No.116	wants DYLS extended and existing DYLS enforced	Safety & Access	Area wide
Stoughton	Manor Road*		need for residents' parking scheme, due to availability issues, particularly since redevelopment of health centre.	Access & Availability of Space	Area wide
Stoughton	Manor Road*		Resident parking permit request due to congestion from non residents & house lets	Access & Availability of Space	Area wide
Stoughton	Martin Road*	Martin Rd coming off New cross Rd	Congestion of parking in Martin Rd coming off New Cross Rd, problems to large or emergency veh	Safety & Access	Area wide
Stoughton	New Cross Street	89	Yellow line revision to DYL across dropped kerb to stop people blocking access	Access & Availability of Space	Area wide
Stoughton	New Cross Street	49	Bay relocation request, due to bays either side driveway gets restricted	Access & Availability of Space	Local
Stoughton	Queen Elizabeth Park development*	corner	junction protection throughout. DYL request as vans park on corner, visibility hazard	Safety & Access	Area wide
Stoughton	Railton Road	in vicinity of accesses to communal parking areas	inconsiderate parking close to accesses cause issues although would prefer mirrors	Safety & Access	Area wide
Stoughton	Regalfield Close*		residents of Worplesdon Road park in road. Wants this and the issues it causes resolved.	Safety, Access & Availability of Space	Area wide
Stoughton	Stoughton Road		wants residents' parking scheme to resolve availability issues	Access & Availability of Space	Area wide
Stoughton	Stoughton Road	btwn mini R/B with Larch Ave down to Hornbeam Rd	DYL request to resolve parking problems btwn mini R/B with Larch Ave down to Hornbeam Rd	Safety & Access	Area wide
Stoughton	Taragon Drive*		increased parking by commercial vehicles owned by residents (particularly No.16) causing issues	Access & Availability of Space	Area wide
Stoughton	Thorpes Close		concerned about loss of parking through creation of vehicle crossovers	Access & Availability of Space	Area wide
Stoughton	Weston Road	parking bays	wants spaces within bays individually marked	Access & Availability of Space	Area wide
Stoughton	Weston Road	in vicinity of No.1a	wants DYLS across driveway removed or replaced with SYL or APM	Access & Availability of Space	Local
Stoughton	Worplesdon Road	to north of New Cross Road junction	inconsiderate parking in vicinity of junction causes issues	Safety & Access	Area wide
Stoughton	Worplesdon Road	service road	want restrictions to stop parking on service roads	Access & Environmental	Area wide
Stoughton	Worplesdon Road	76-78	DYL restriction in addition to the existing advisory access protection markings to prevent parking on carriageway and adjacent footway, to protect access to individual/private point of vehicle onto public highway	Access	Area wide & Local
Stoughton	Manor Crescent	Throughout but particularly close to Manor Road	parking restricts ability to use footways and inhibits emergency access.	Safety & Access	Area wide
Stoughton*	Burpham Lane & King Post	crossing	Parking worse since controls put in place esp at crossing. Also delivery vans park on pavement + over crowding. Better parking solutions	Access & Availability of Space	Area wide

Non-CPZ List for Consideration - ANNEXE 3

Division(s) / Ward(s)	Road	Location	Issue / Request	Reason Given	Area-wide / Local
Westborough	Aldershot Road	junct with Hillview	Vehicles park at aldershot rd junct with hillview & cause obstruction	Safety & Access	Area wide
Westborough	Aldershot Road*	opposite Co-op store	want disabled bay introduced to aid those customers with mobility issues and limited waiting to improve the turnover of space	Access & Availability of Space	Area wide
Westborough	Anston Court		Disabled bay no longer in use as resident moved	Access & Availability of Space	Local
Westborough	Applegarth Avenue	green in front of Nos.22-48	parking associated with student households in the area causing availability issues and damage to grass verges	Availability of Space & Environmental	Area wide
Westborough	Beckingham Road	cul-de-sac end	Parking on opposite houses, often on footways causes issues & opposite driveways	Safety & Access	Area wide
Westborough	Belmont Avenue	junction with Worplesdon Road	inconsiderate parking in proximity of junction causes issues	Safety & Access	Area wide
Westborough	Belmont Avenue		DYL req both sides as narrow & cars have to drive in the middle of road	Safety & Access	Area wide
Westborough	Broomfield		inconsiderate parking causes issues	Safety & Access	Area wide
Westborough	Dunmore		insufficient parking for residents exacerbated by protection of grass verges / creation of flowerbeds (GBC Housing).	Access & Availability of Space	Area wide
Westborough	Foxburrows Avenue		inconsiderate parking by hospital staff and students causes issues, including ones of availability of space	Safety, Access & Availability of Space	Area wide
Westborough	Grantley Road / Weston Road	on pavements	want measures / enforcement to prevent inconsiderate parking on footways	Safety & Access	Area wide
Westborough	Greville Close		Disabled Parking Formalisation	Access & Availability of Space	Area wide
Westborough	Greville Close*		inconsiderate parking on junctions, bends and in garage blocks by non-residents causing issues, including availability and suggestion of residents' parking.	Safety, Access & Availability of Space	Area wide
Westborough	Greville Close*	block entrance to 3	non residents cars block entrance as DYL to short, need extension and both sides to entrance and/or parking restrictions/permits	Safety & Access	Area wide
Westborough	Hanna Gardens /Aldershot Rd	exit hanna gardens	DYL to fix visibility when exit hanna gardens, like aldershot read	Safety & Access	Area wide
Westborough	Oakfields, Guildford	driveway access	request & parking controls due to access being blocked & have disabled child	Safety & Access	Area wide
Westborough	Park Barn Drive	junct	SYL req due to congestion of cars so junct preserved & also residents to park there outside peak times	Access & Availability of Space	Area wide
Westborough	Parkhurst Road*		parking in vicinity of driveways cause issues and formalised parking controls / residents' parking is required	Safety, Access & Availability of Space	Area wide
Westborough	Roundhill Way	Roundhill Way meets Foxborrows Ave	parking congestion from commuters to Uni and repair company causes lack of parking for residents and hazards when parked on pavement	Access & Availability of Space	Area wide
Westborough	Rydes Hill Road* & Clayton Drive		wants DYL on one side, and around 90-degree bends, to prevent inconsiderate parking and on Clayton Drive. Also issues around junction with Rydes Avenue.	Safety & Access	Area wide
Westborough	Sheepfold Road*		lines almost gone and cars parking on road/pavement	Safety & Access	Area wide
Westborough	Shepherds Hill	Near junction with Worplesdon Rd	DYL req on corner of Shepherds Hill and Worplesdon Rd, cars parked dangerously	Safety & Access	Area wide
Westborough	Southway*	service road (req btwn Sthwat from vernon way to RB at park Barn	wants a review of recently introduced controls as parking issues continue to grow, increasing danger, threatening behaviour and obstruction. Also yellow lines for driveways.	Safety, Access & Availability of Space	Area wide
Westborough	Southway*	near No.147	parking by non-residents causes availability issues for residents. Permit scheme required	Access & Availability of Space	Area wide

Non-CPZ List for Consideration - ANNEXE 3

Division(s) / Ward(s)	Road	Location	Issue / Request	Reason Given	Area-wide / Local
Westborough	Southway*	near A3 pedestrian underpass to Egerton Road	parking by non-residents leaves little parking for residents and their visitors	Access & Availability of Space	Area wide
Westborough	Vernon Way	dropped kerb access	have dropped kerb + white line but keep getting blocked in/out. Also vehicles parked on kerb so problem for pedestrians	Safety & Access	Local
Westborough	Weston Road	between Parkhurst Road & Grantley Road	existing restrictions need to be extended to resolve issue caused by inconsiderate parking	Safety & Access	Area wide
Westborough	Woodside Road*	adjacent to No.120 Southway	indistinct crossover leads to issues of obstruction. Congestion on both sides inc pavement, as narrow makes difficult to pass and problems for pedestrians	Access & Availability of Space	Area wide
Worplesdon	Barnwood Road		inconsiderate parking causes issues	Safety & Access	Area wide
Worplesdon	Berry Lane, Fox Corner	on verges	corresp with high ways but cant see subject	Safety & Access	Area wide
Worplesdon	Broad Street	outside Rydes Hill prep school	wants parking on verges prevented	Safety, Access & Environmental	Area wide
Worplesdon	Cranstoun Close		particular households parking on footway cause issues	Safety & Access	Area wide
Worplesdon	Ecob Close	footways	inconsiderate pavement parking by a resident with a van	Safety & Access	Area wide
Worplesdon	Keens Lane*	throughout but particularly near Sime Close and some of the other cul-de-sacs of Keens Lane	inconsiderate and footway parking close to junctions causes issues	Safety & Access	Area wide
Worplesdon	Perry Hill	service road in vicinity of White Lyon and Dragon public house	inconsiderate parking by customers causes issues	Access & Availability of Space	Area wide
Worplesdon	Salt Box Road	near car parks	proposed charging in private car parks off Salt Box Road could lead to on-street parking issues. To be advised.	Safety, Access & Traffic Flow	Area wide
Worplesdon	St Michael's Avenue, Fairlands		Yellow line restriction extended to cover lengths of carriageway between jnct, prevent vans/large vehicles parking carriageways/verges	Access & Environmental	Local
Worplesdon	Stringers Avenue, Jacobs Well *	near junction with Queenhythe Rd	parking on footway and verge	Safety	Area wide
Worplesdon	White Hart Lane	in vicinity of White Hart PH	parking in lane restricts with and would prevent access for emergency vehicles	Safety & Access	Area wide
Worplesdon	Wildfield Close		existing advisory markings ineffective at preventing obstruction. Unspecified controls	Safety & Access	Area wide
Worplesdon	Worplesdon Road	in vicinity of Ship Cottage	inconsiderate parking on footway close to access causes issues	Safety & Access	Area wide

This page is intentionally left blank



Key to Existing Restriction Types Displayed

-  LW 3Hrs nr 3Hrs M-S
8.30am-6pm
-  No Waiting At Any Time
-  No Waiting Mon-Sat
8.30am-6pm



Reproduced from Ordnance Survey Material.
HMSO Crown Copyright. All rights reserved.
Guildford Borough Council
Licence No: 100019625, 2018

Guildford parking review
Draft proposals for
Merrow Street
ITEM XX ANNEXE 4

SCALE	1 : 1750 @ A3
DATE	10/08/2018
DRAWING No.	GBC/APH/MerrowStProp18
DRAWN BY	ANDREW HARKIN

This page is intentionally left blank

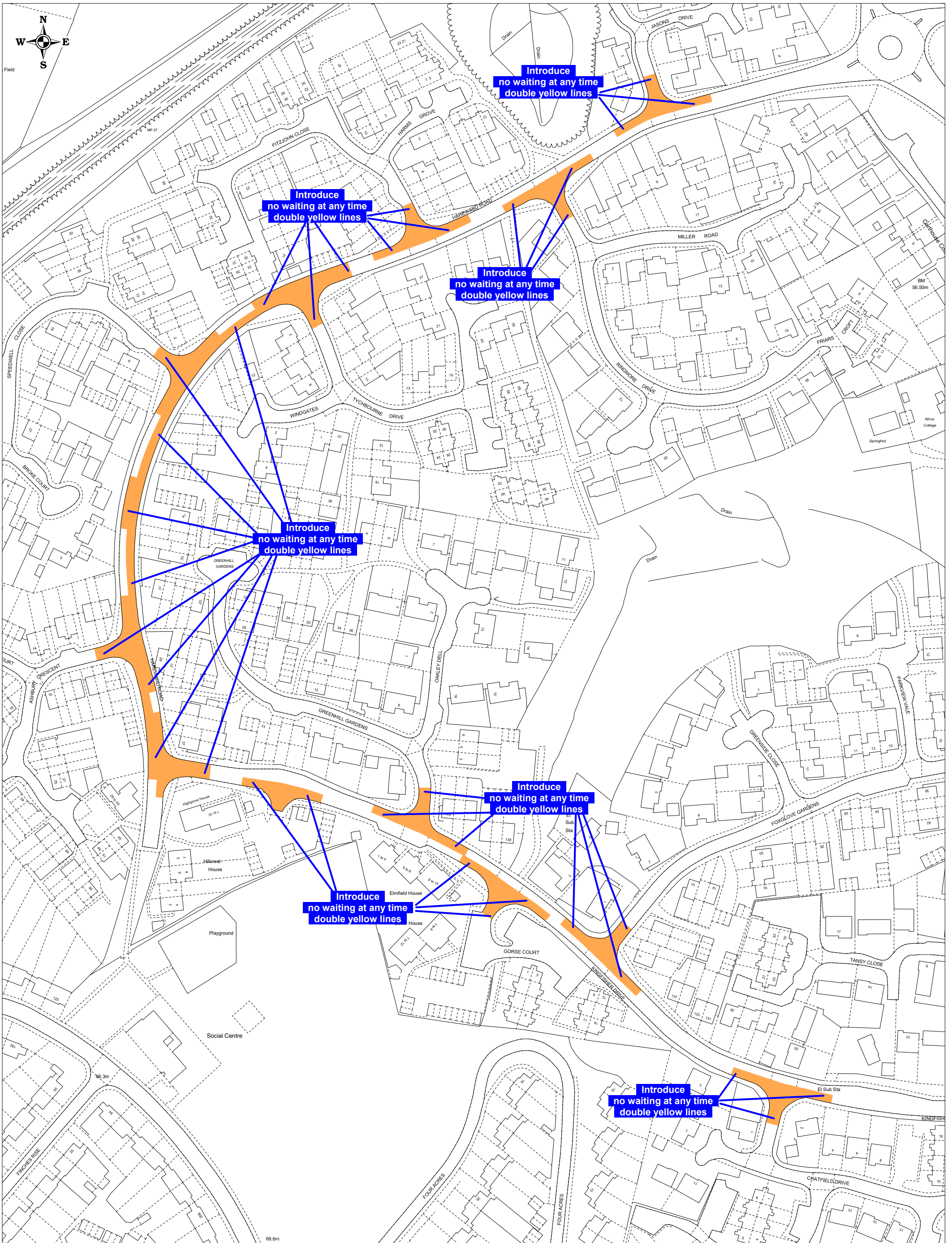

Reproduced from Ordnance Survey Material.
 HMSO Crown Copyright. All rights reserved.
 Guildford Borough Council
 Licence No: 100019625, 2018

Guildford parking review
 Draft proposals for
 Hareward Road area
 ITEM XX ANNEXE 5

SCALE	1 : 1500 @ A3
DATE	10/08/2018
DRAWING No.	GBC/APH/HarewardProp18
DRAWN BY	ANDREW HARKIN

This page is intentionally left blank

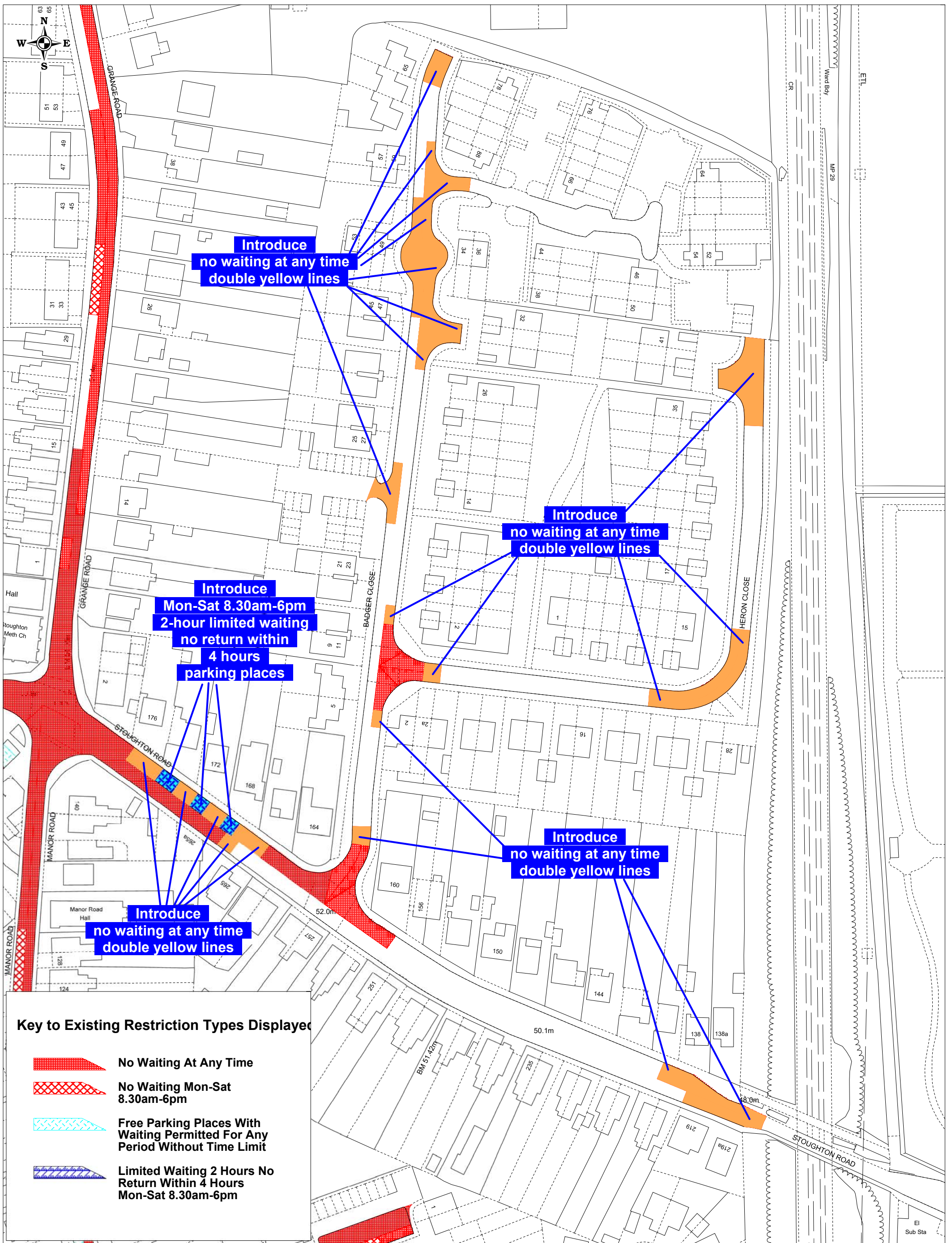

Key to Existing Restriction Types Displayed

-  **No Waiting At Any Time**
-  **No Waiting Mon-Sat 8.30am-6pm**
-  **Free Parking Places With Waiting Permitted For Any Period Without Time Limit**
-  **Limited Waiting 2 Hours No Return Within 4 Hours Mon-Sat 8.30am-6pm**

Reproduced from Ordnance Survey Material.
 HMSO Crown Copyright. All rights reserved.
 Guildford Borough Council
 Licence No: 100019625, 2018

Guildford parking review
 Draft proposals for
 Stoughton Road Area
 ITEM XX ANNEXE 6

SCALE	1 : 1000 @ A3
DATE	06/09/2018
DRAWING No.	GBC/APH/StoughtonAreaProp18
DRAWN BY	ANDREW HARKIN





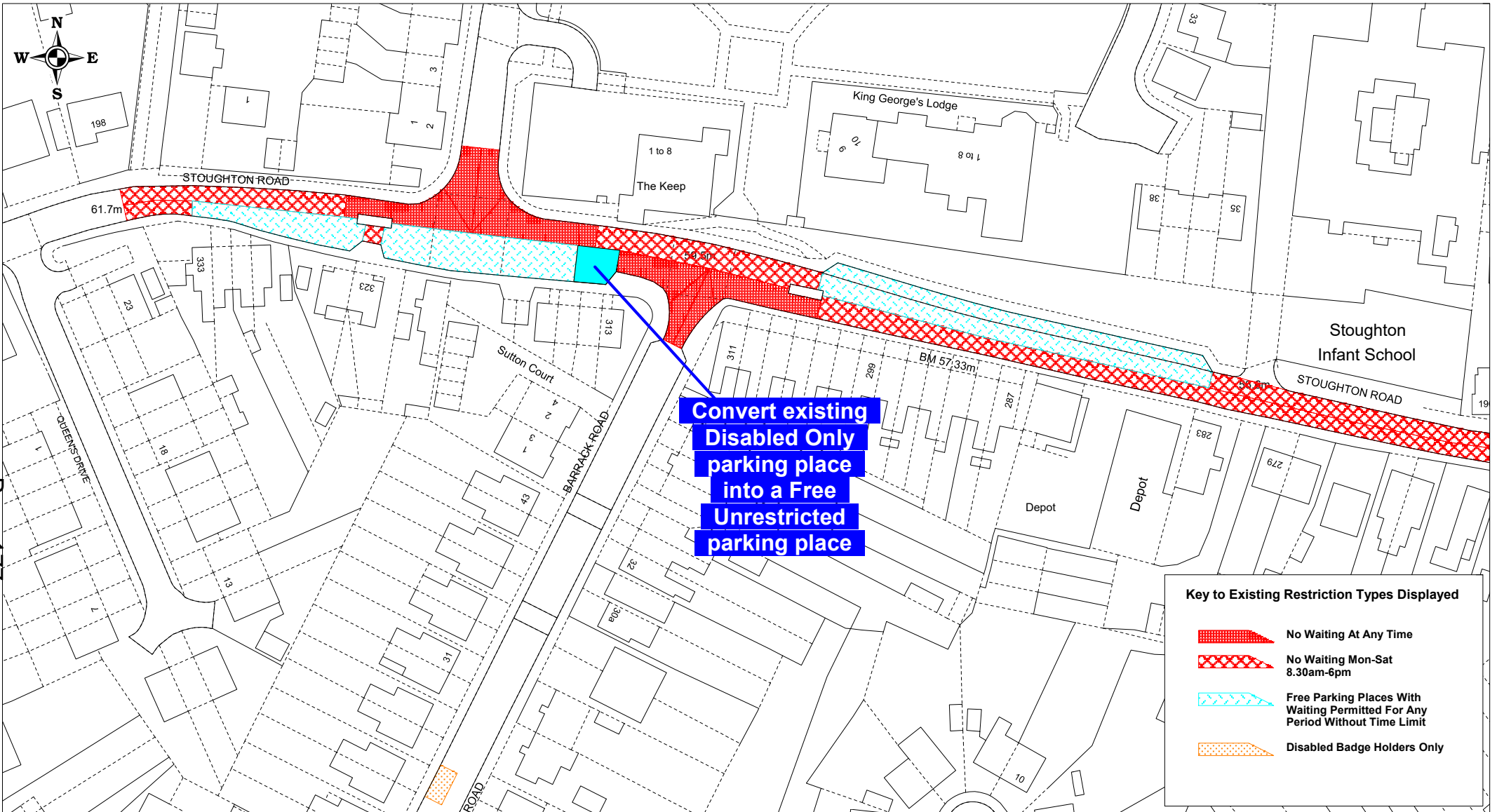

This page is intentionally left blank



Convert existing
Disabled Only
parking place
into a Free
Unrestricted
parking place

Key to Existing Restriction Types Displayed

-  No Waiting At Any Time
-  No Waiting Mon-Sat 8.30am-6pm
-  Free Parking Places With Waiting Permitted For Any Period Without Time Limit
-  Disabled Badge Holders Only



Reproduced from Ordnance Survey Material.
HMSO Crown Copyright. All rights reserved.
Guildford Borough Council
Licence No. 100019625, 2018

Guildford parking review
Draft proposals for
Stoughton Road
ITEM XX ANNEXE 7

SCALE	1 : 1000 @ A4
DATE	31/08/2018
DRAWING No.	GBC/APH/StoughtonRdDisProp18
DRAWN BY	ANDREW HARKIN

This page is intentionally left blank



Reproduced from Ordnance Survey Material.
 HMSO Crown Copyright. All rights reserved.
 Guildford Borough Council
 Licence No. 100019625, 2018

Guildford parking review
 Draft proposals for
 Artillery Terrace
 ITEM XX ANNEXE 8

SCALE	1 : 1000 @ A4
DATE	31/08/2018
DRAWING No.	GBC/APH/ArtilleryTrProp18
DRAWN BY	ANDREW HARKIN

This page is intentionally left blank